



UNIVERSITÄTS-
BIBLIOTHEK
PADERBORN

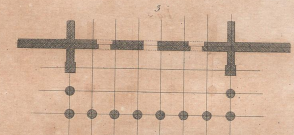
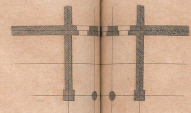
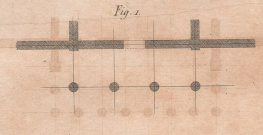
**Abriß der Vorlesungen über Baukunst gehalten an der
Königlichen Polytechnischen Schule zu Paris**

Durand, Jean-Nicolas-Louis

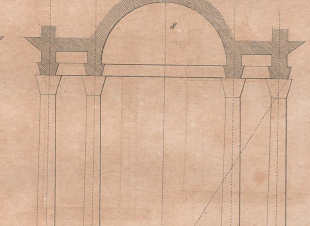
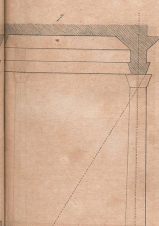
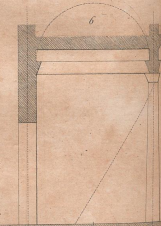
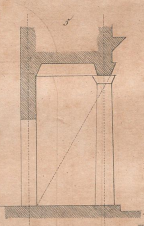
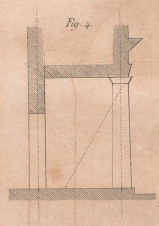
Carlsruhe [u.a.], 1831

2ther Theil.

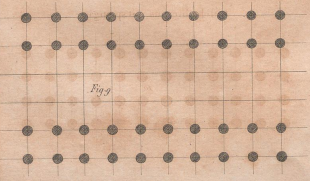
[urn:nbn:de:hbz:466:1-64213](https://nbn-resolving.org/urn:nbn:de:hbz:466:1-64213)



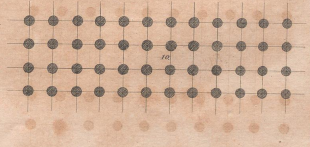
Verschiedene Besten der Hallen



Neue Verbindungen



welche hieraus entspringen



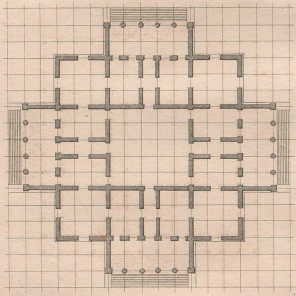


Fig. 1

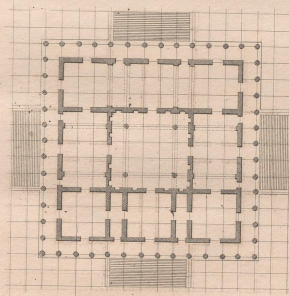
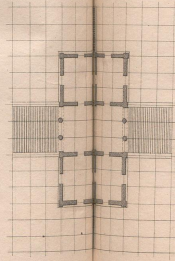
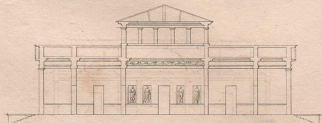


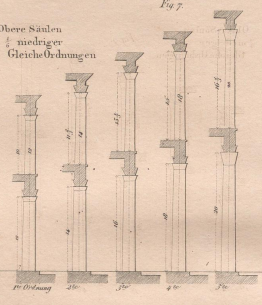
Fig. 5



VERTICALITÄTEN

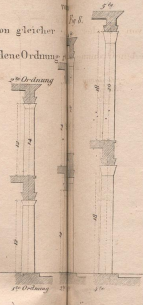
Obere Säulen
& niedriger
Gleiche Ordnungen

Fig. 7.



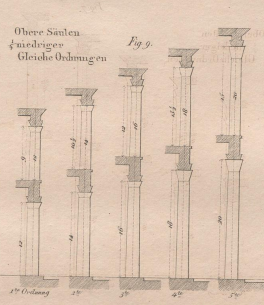
Säulen von gleicher
Höhe
Verschiedene Ordnungen

Fig. 8.



Obere Säulen
& niedriger
Gleiche Ordnungen

Fig. 9.



deren Stukwerke gleich sind

ANWENDUNGEN

deren oberes höher ist

deren oberes Stukwerk niedriger ist

Fig. 5.

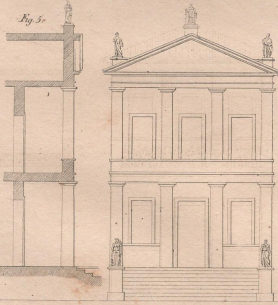


Fig. 1.

Fig. 1.

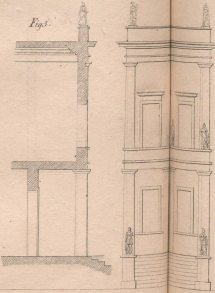


Fig. 4.

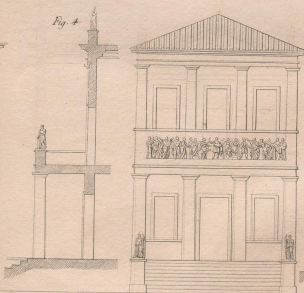
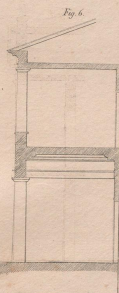
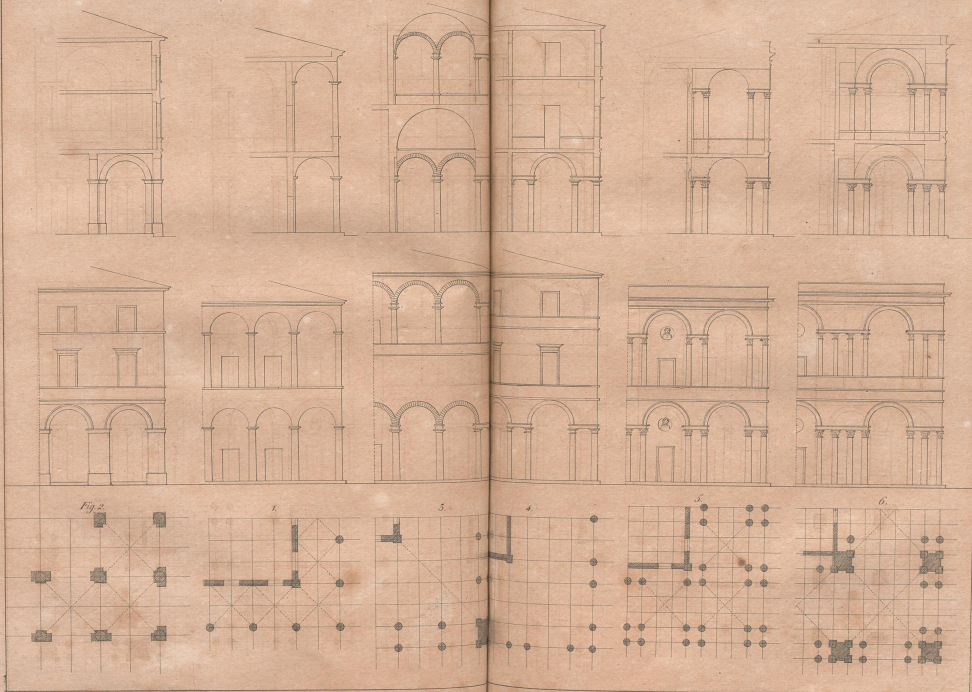


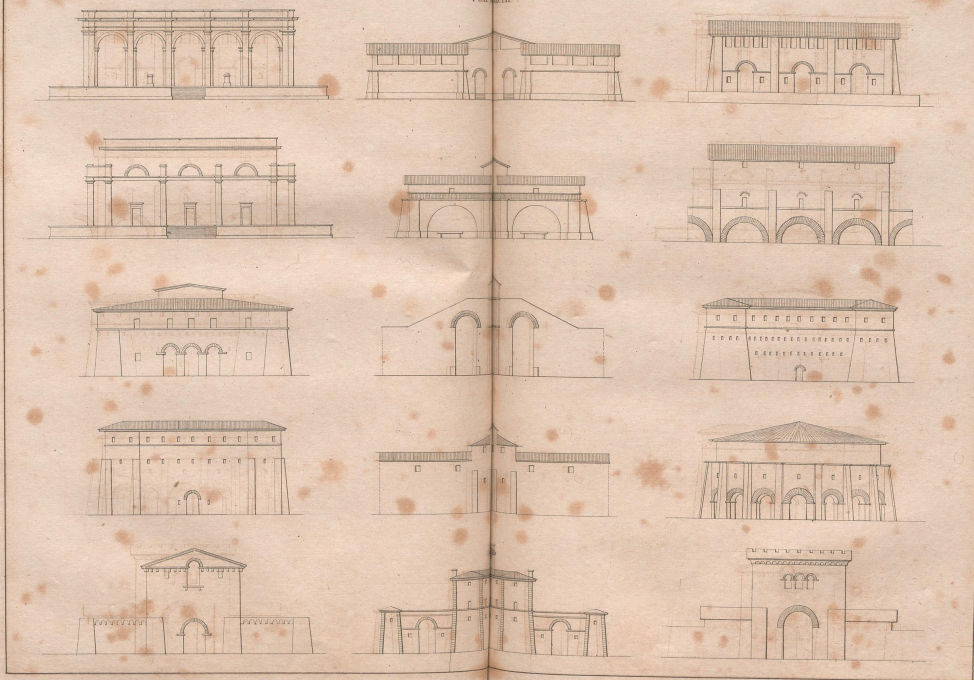
Fig. 2.

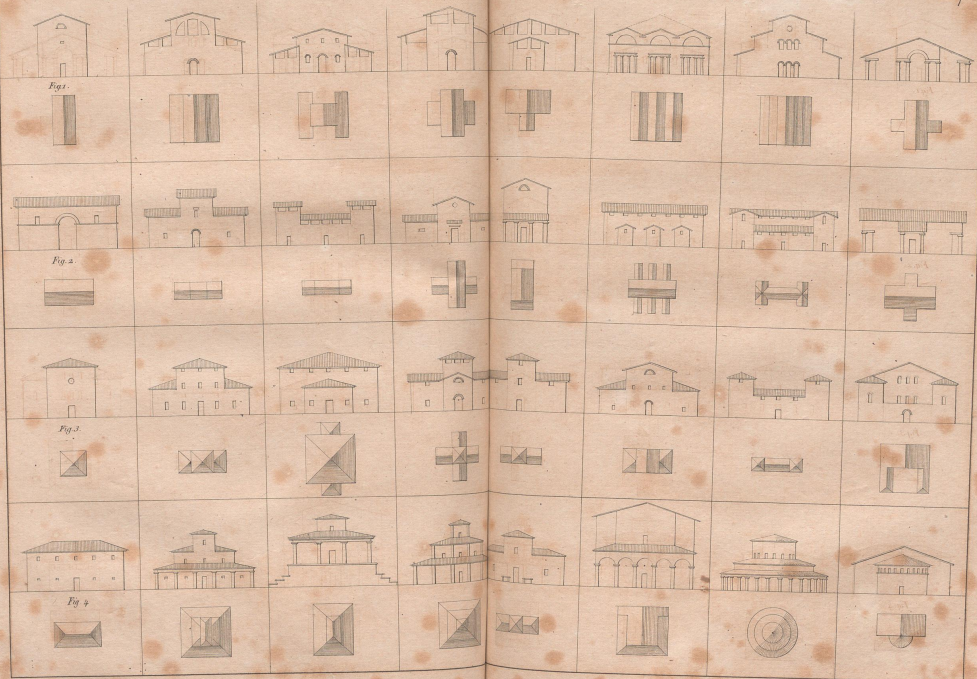
Fig. 6.

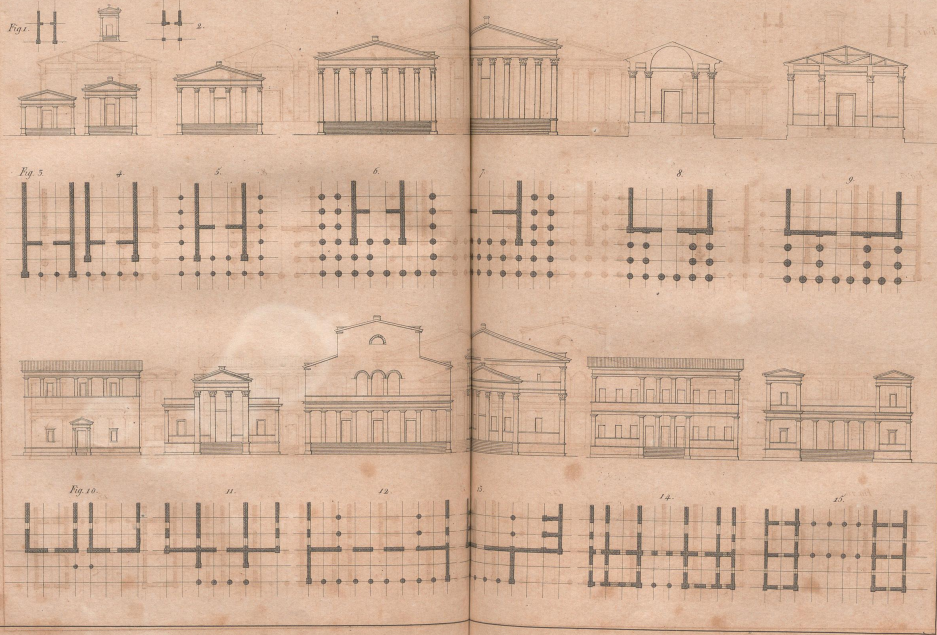


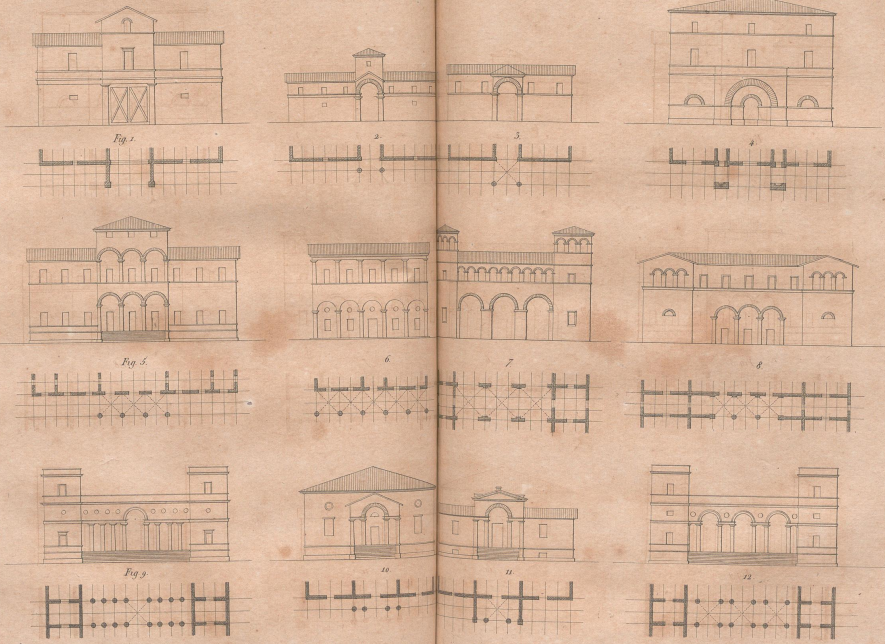


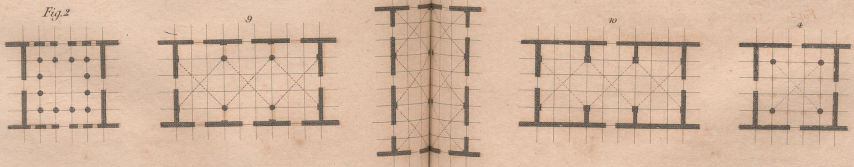
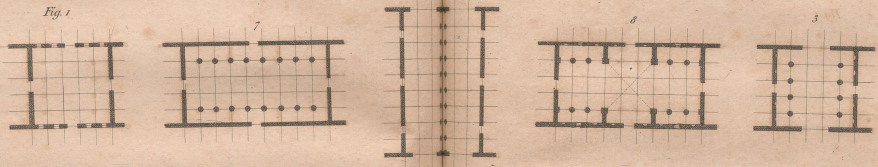
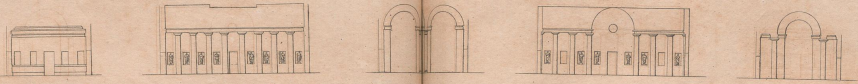


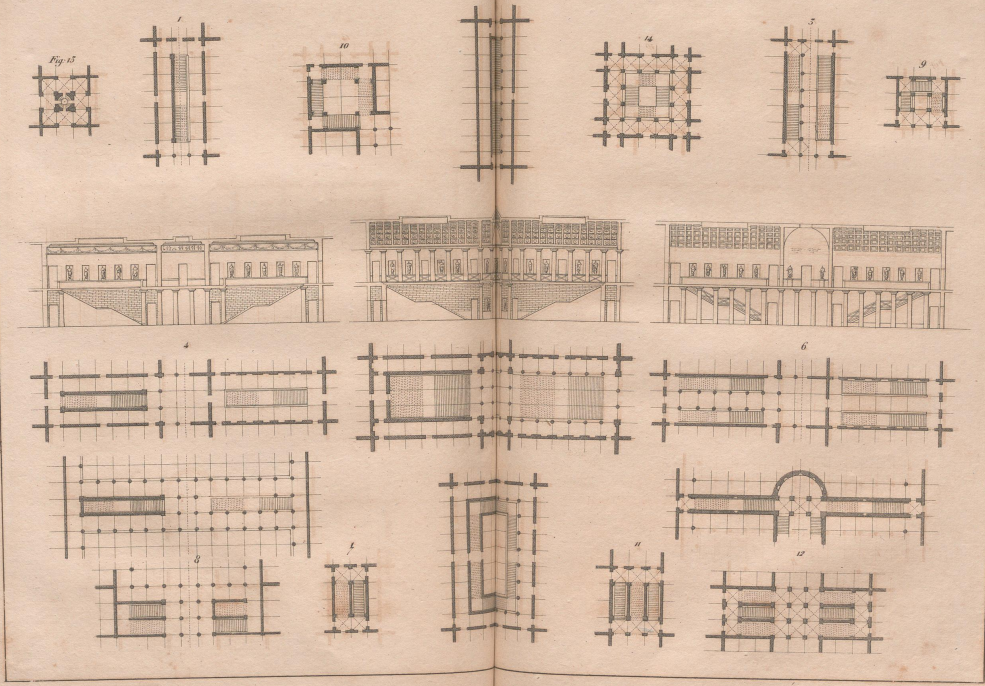












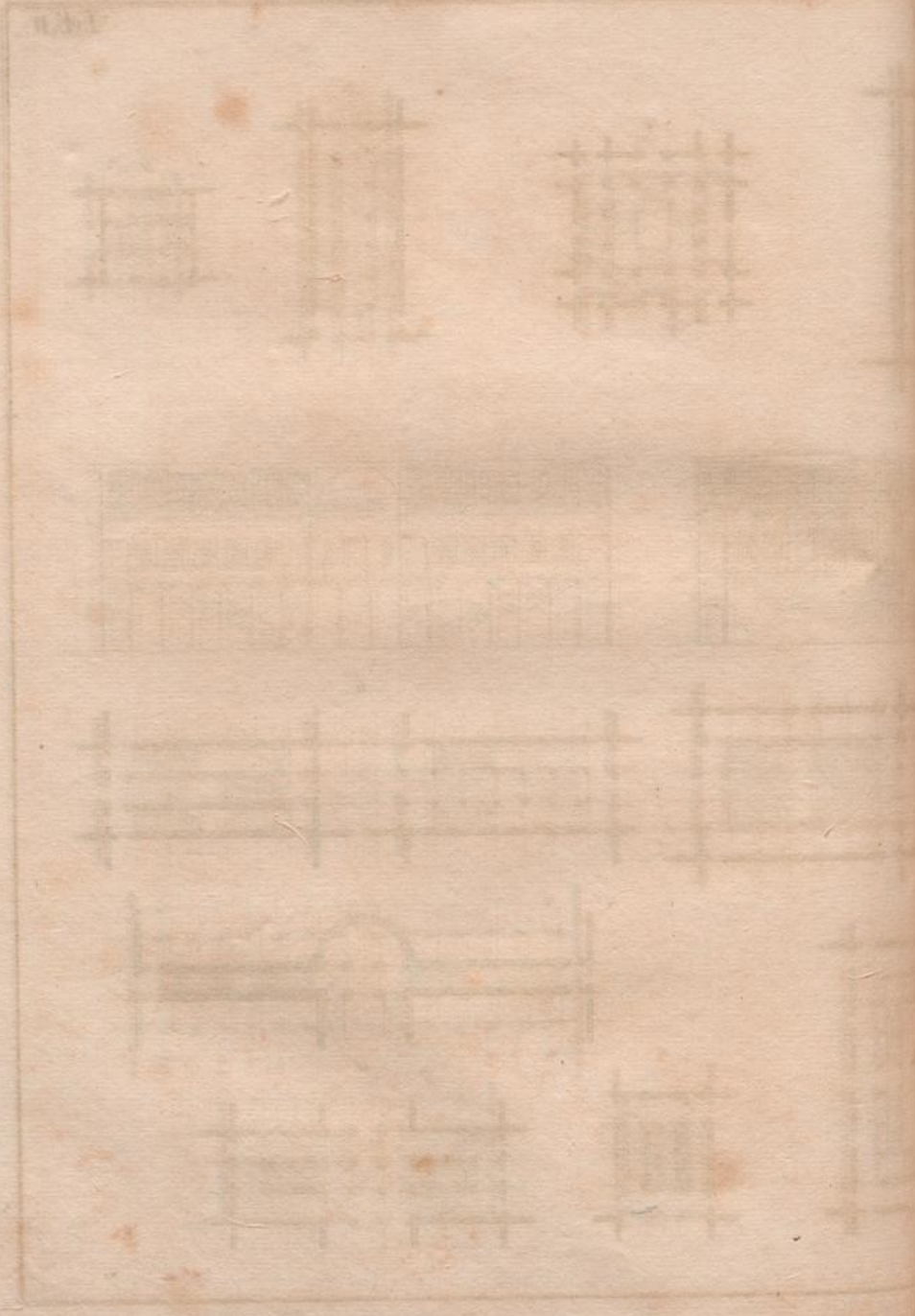
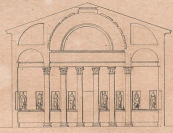




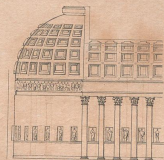
Fig. 6



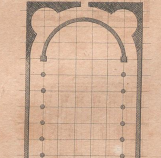
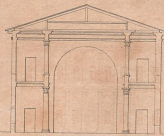
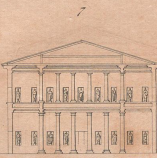
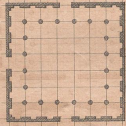
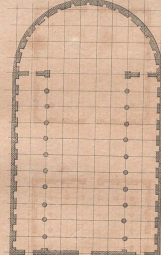
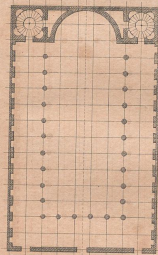
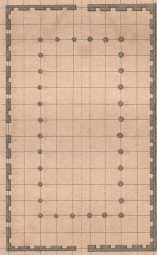
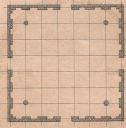
1



2



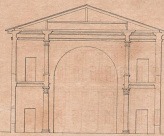
3



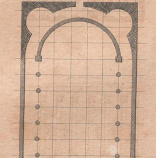
5



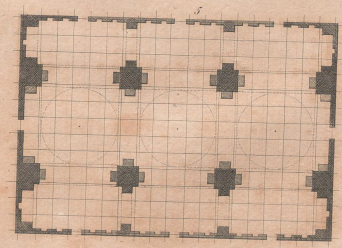
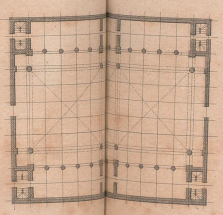
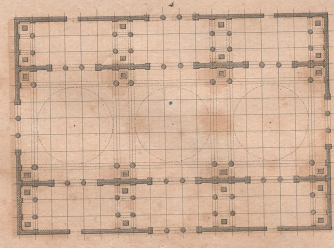
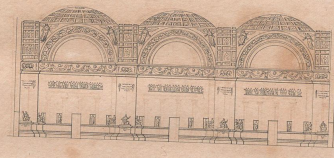
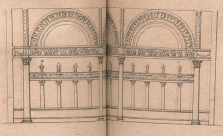
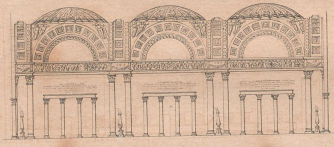
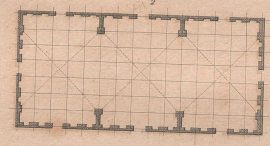
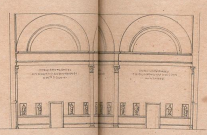
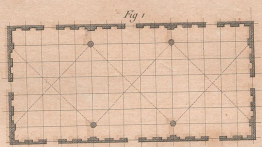
7



7



8



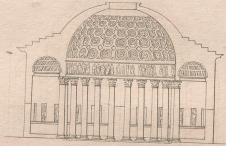
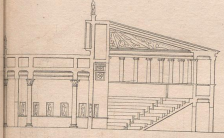
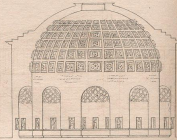
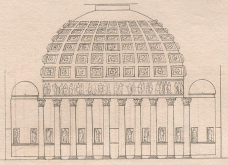


Fig. 4.

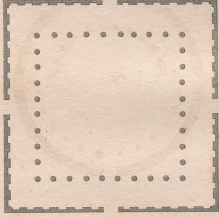


Fig. 1.

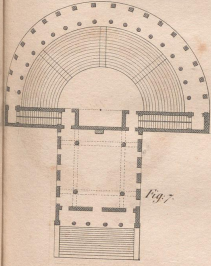


Fig. 7.

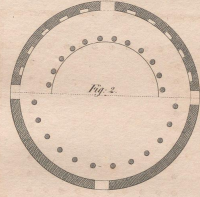


Fig. 2.

Fig. 3.

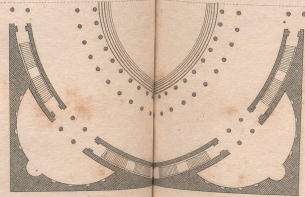
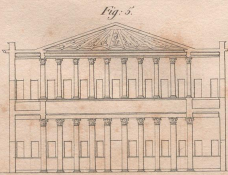
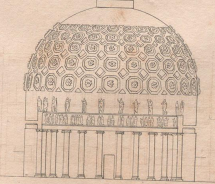
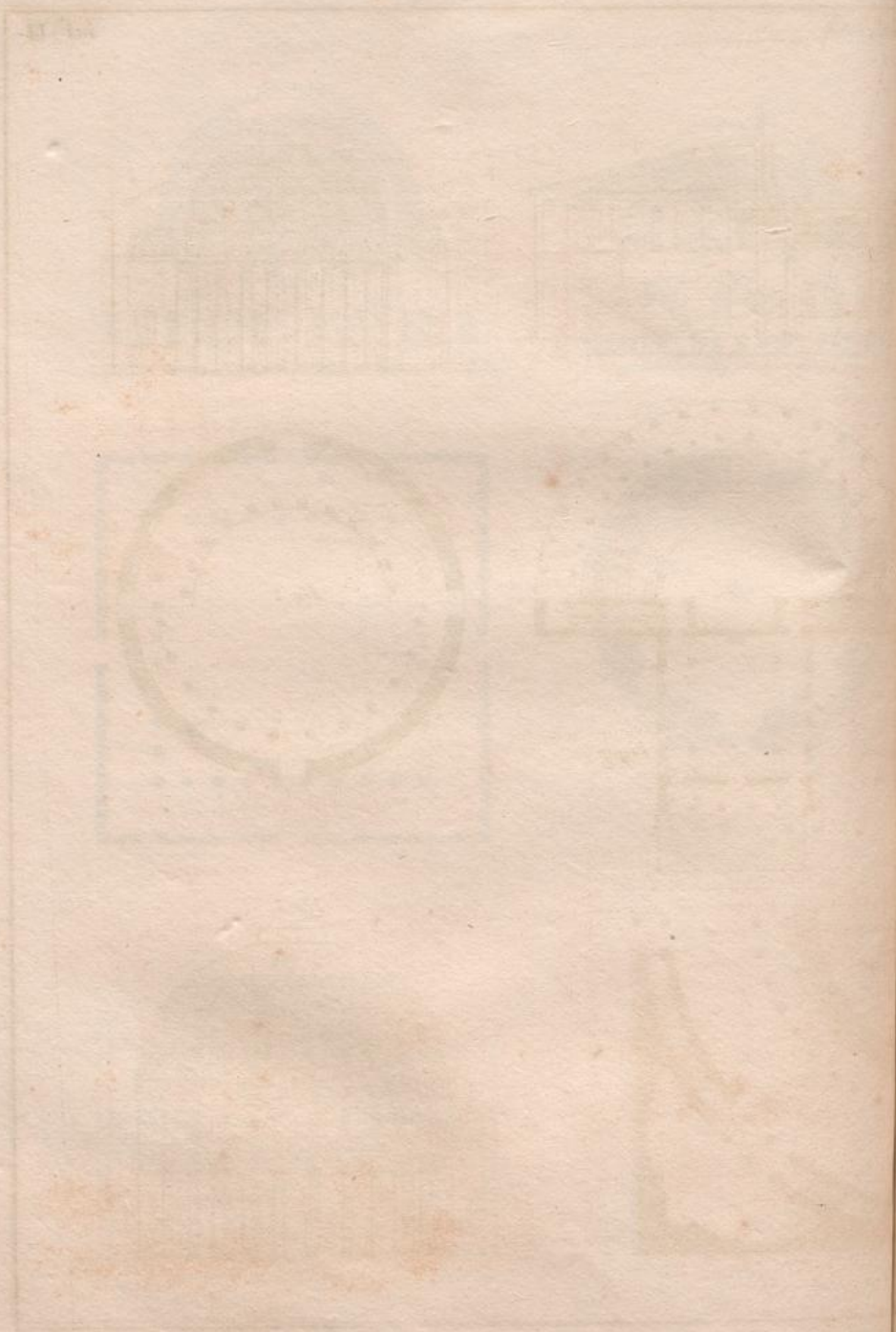
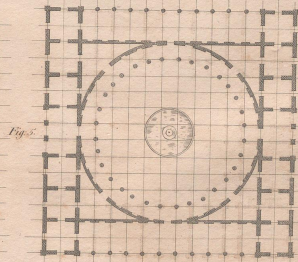
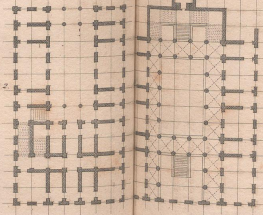
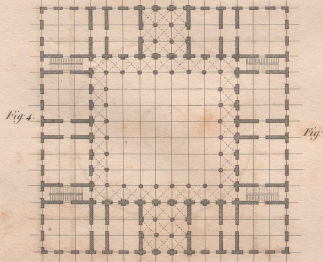
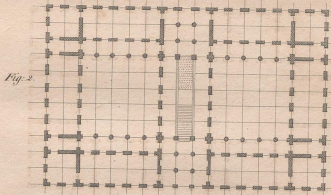
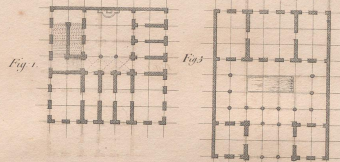
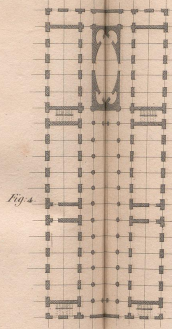
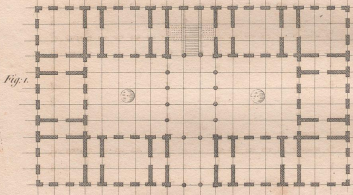
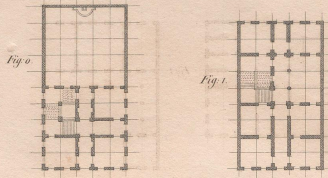
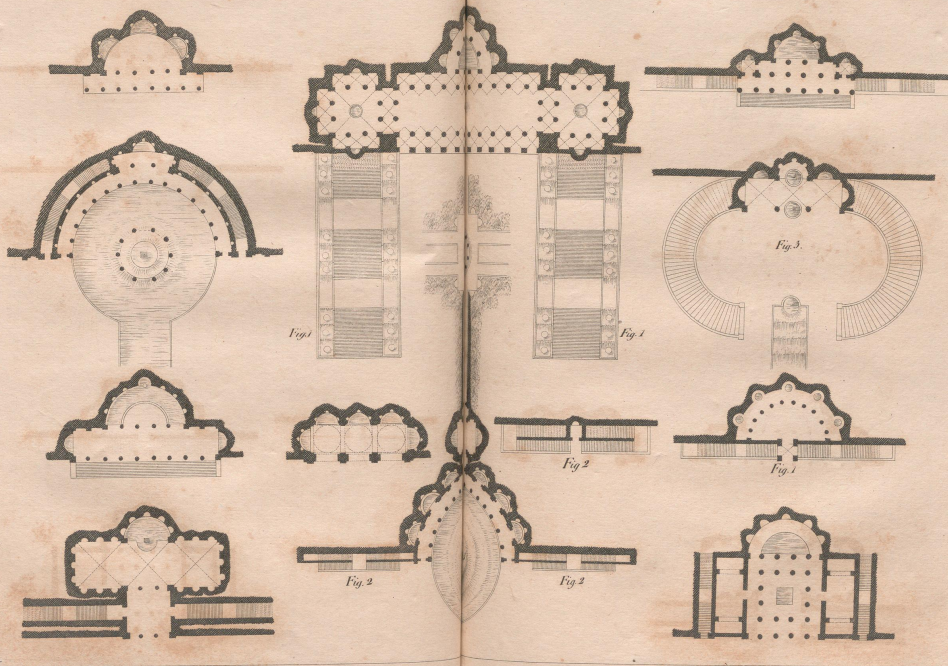


Fig. 5.

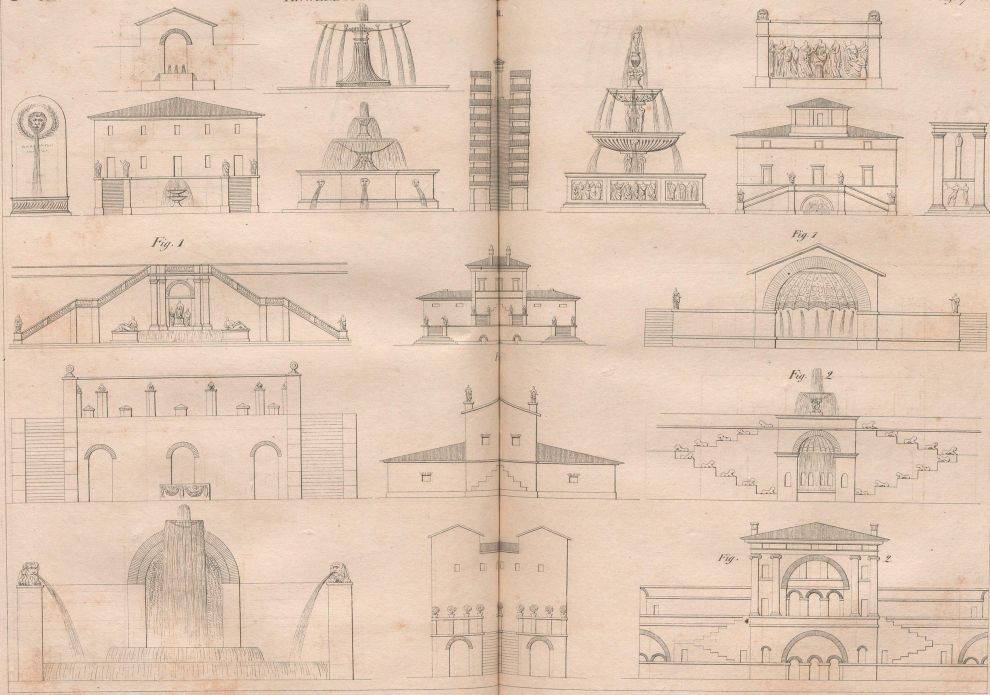


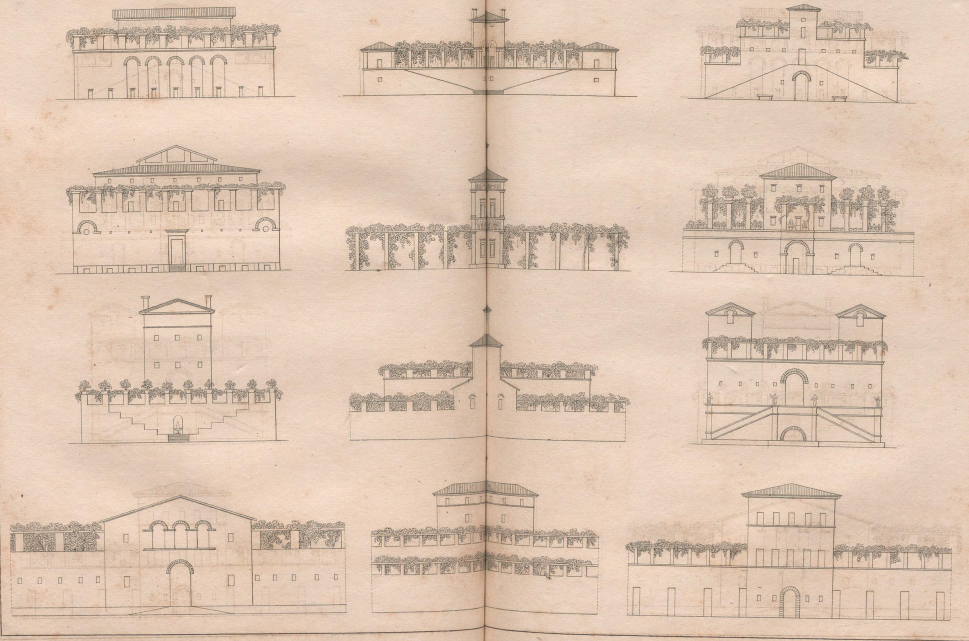


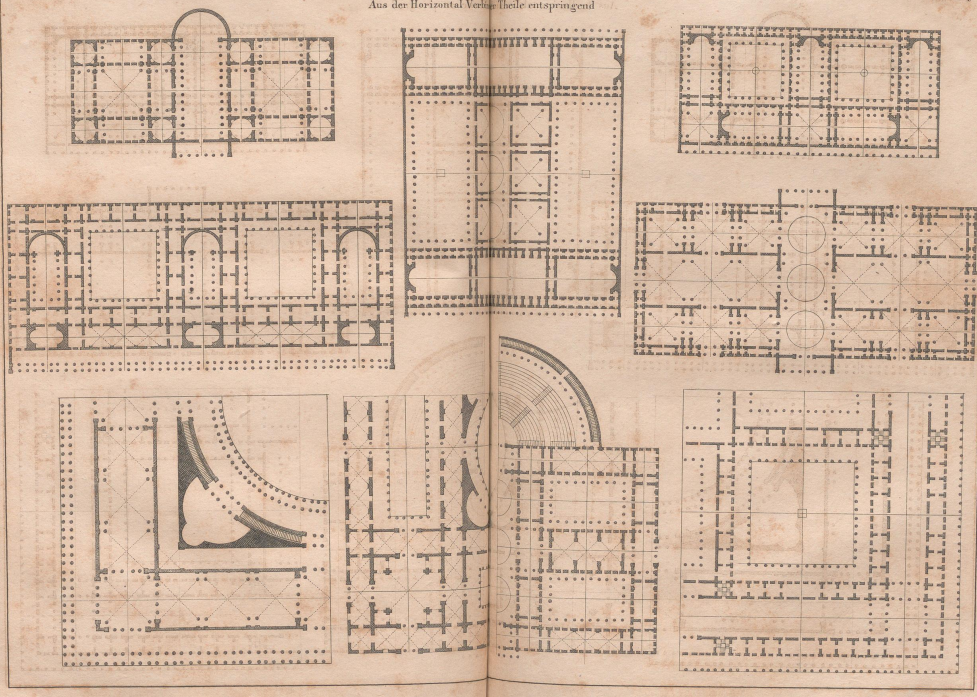










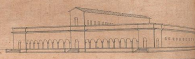


GANZEDE
Aus verschiedenen Horizontal- und -Verbindungen entstehend.

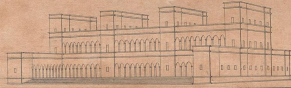
nach dem Quadrate



in zweytheil



in drey



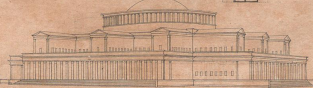
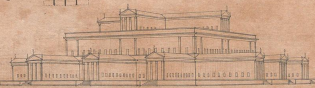
in drey

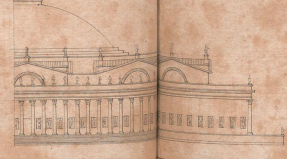
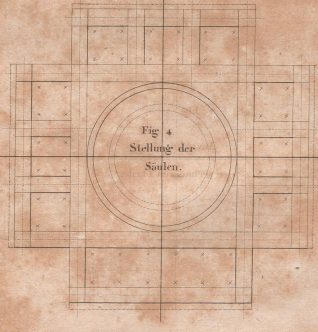
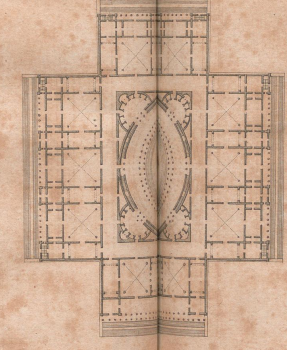
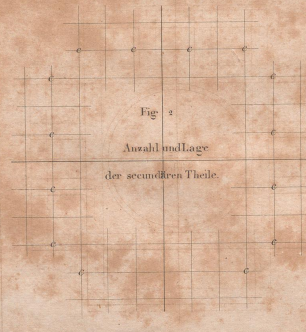
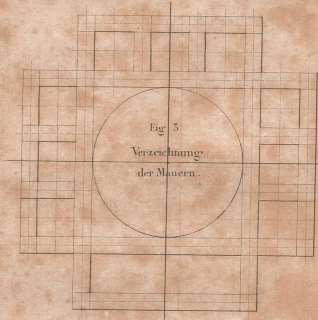


in vier



in vier





P. C.

