



UNIVERSITÄTS-
BIBLIOTHEK
PADERBORN

Die Bauformen des Mittelalters in Sandstein

Opderbecke, Adolf

Weimar, 1882

Taf. XXVII.

[urn:nbn:de:hbz:466:1-67077](https://nbn-resolving.org/urn:nbn:de:hbz:466:1-67077)

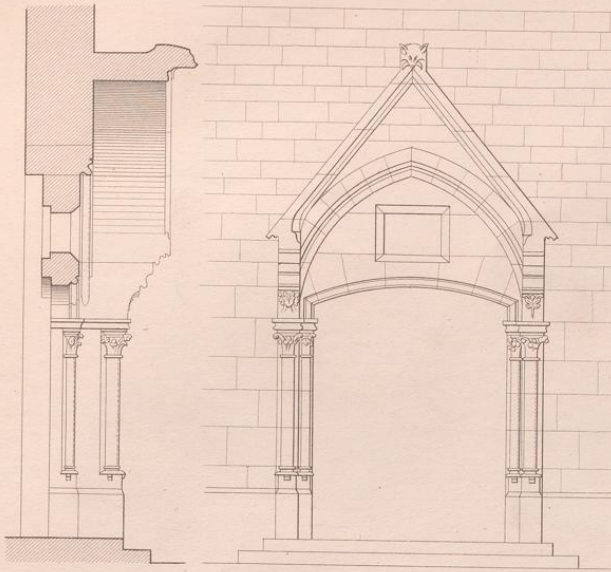

Fig. 311.
Frühgoth. Portal mit
Giebel - Ueberdachung
XIII. Jahrh. n.V.D.

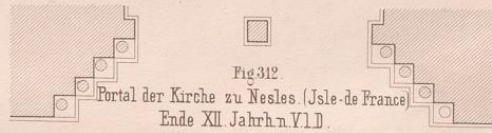
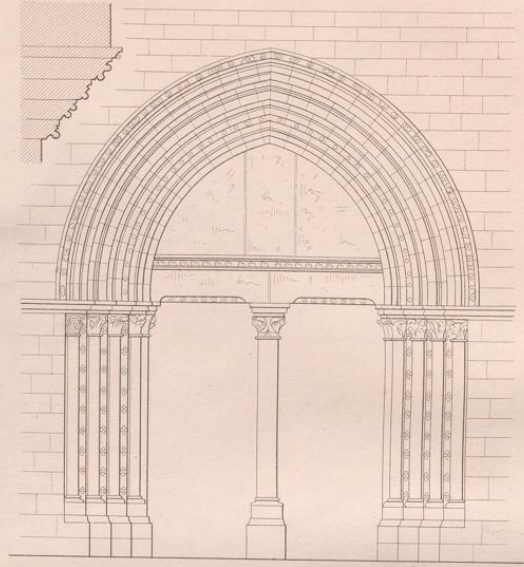
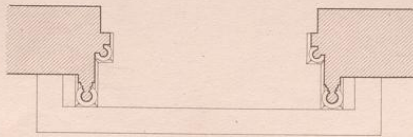

Fig. 312
Portal der Kirche zu Nesles. (Isle-de-France)
Ende XII. Jahrh. n.V.D.

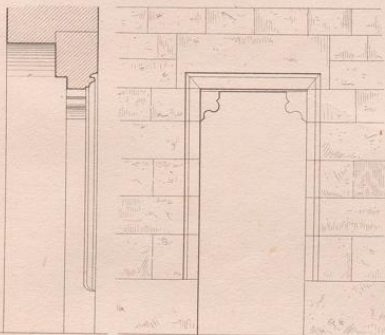

Fig. 313.
Thüre vom Ende d. XIII. Jahrh. n.V.D.

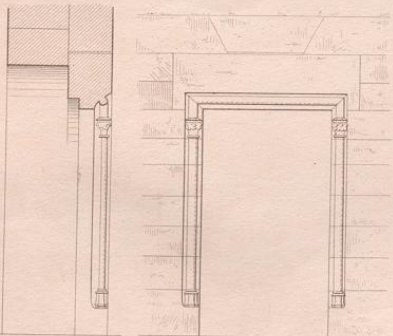

Fig. 314.
Thüre aus d. XIV. Jahrh. n.V.D.



Fig. 315.
Portal v. St. Martin zu Colmar XIII. Jahrh. Kunst. Bildg.

Opferbede's Bauformen.

