



UNIVERSITÄTS-
BIBLIOTHEK
PADERBORN

**Vorlagen für den gewerblichen Fachunterricht an
technischen Lehranstalten insbesondere an
Gewerbeschulen**

Kircher, Philipp

Karlsruhe, [1886 - 1889]

III. Steinhauerarbeiten.

[urn:nbn:de:hbz:466:1-97992](https://nbn-resolving.org/urn:nbn:de:hbz:466:1-97992)

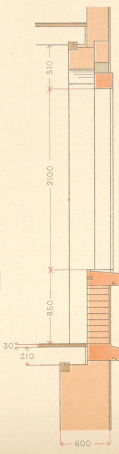
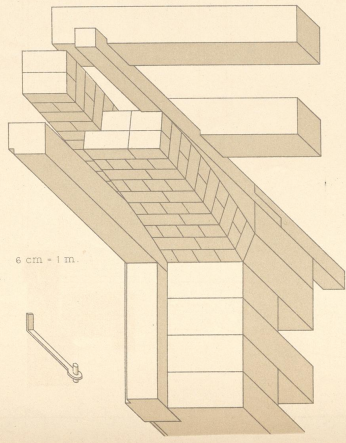

Fenster des II Stocks.

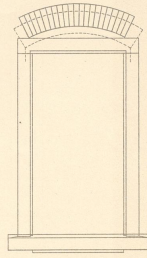

Massst: 3 cm = 1 m

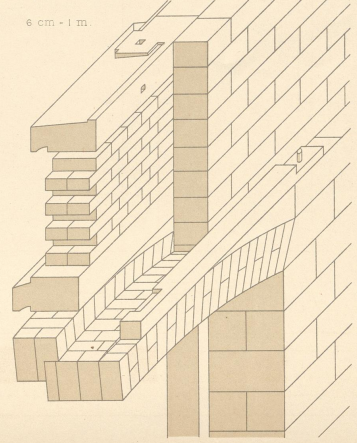
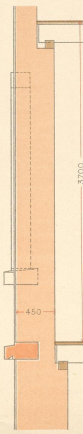
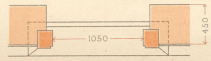

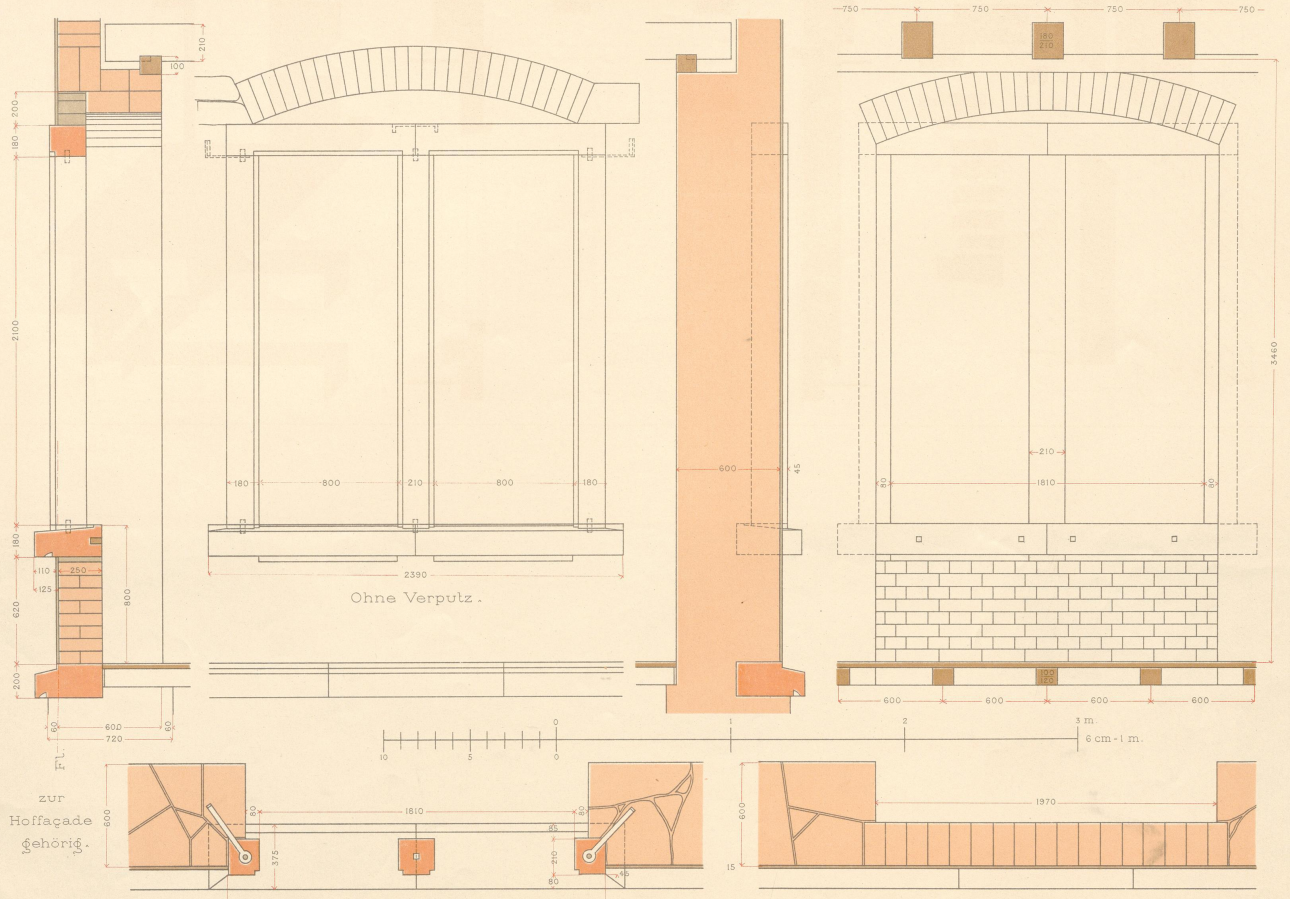

Wohnort und Datum.

Namen.

06
WTG
1/199



EK 938
K D/XV

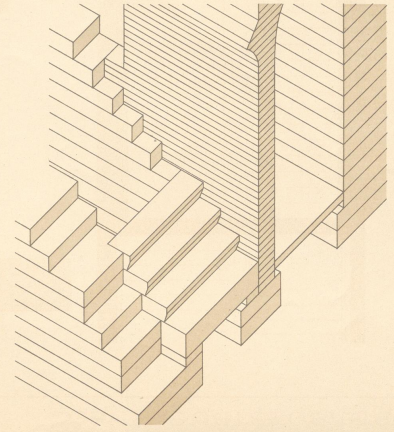
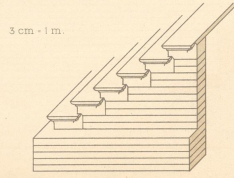
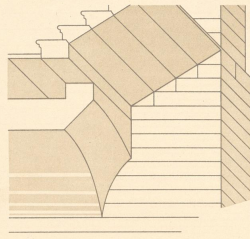
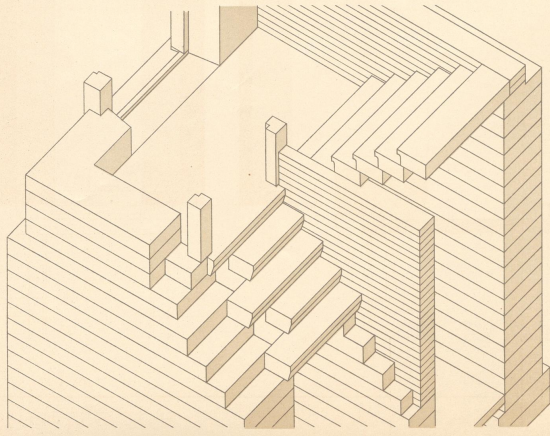

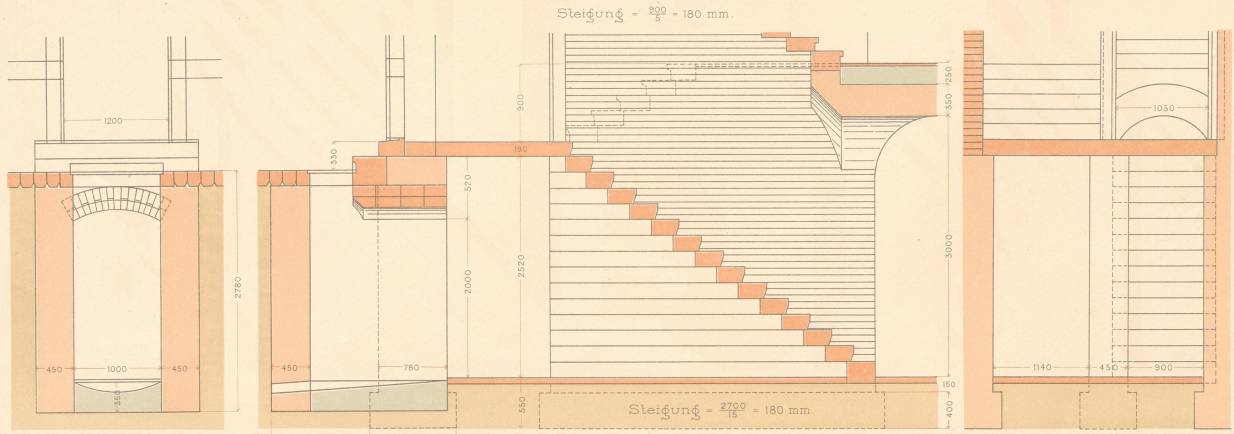

Schnitt CD.

Schnitt AB.

Schnitt EF.

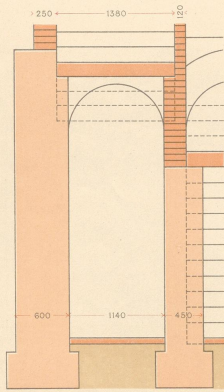

Schnitt GH.

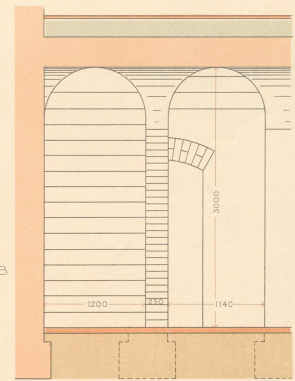
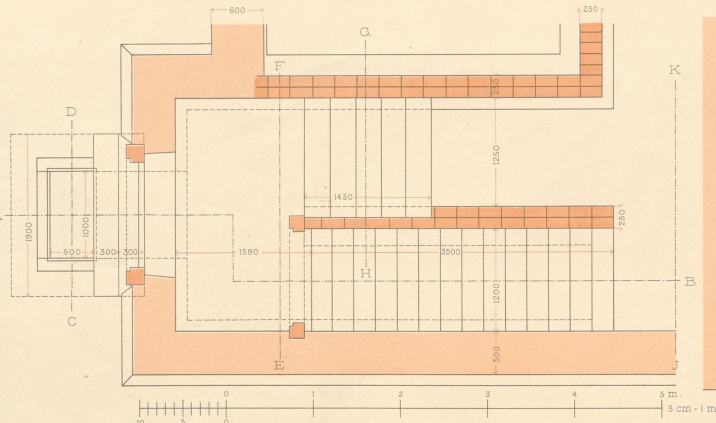

Schnitt JK.

Wohnort und Datum.

Namen.

06
WTC
/199



EK 938
K D/V

Schnitt A B.

Ansicht der westlichen Ecke des Wohnhaussockels.

Schnitt C D.

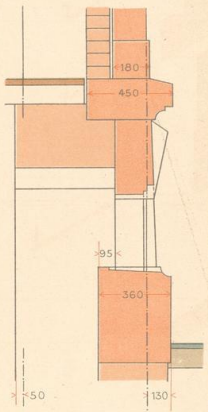
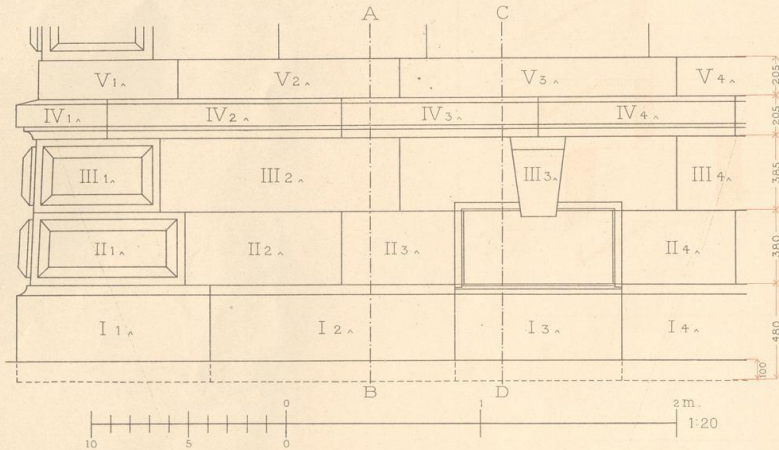
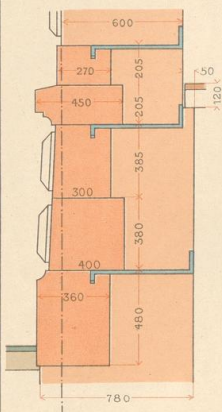

Fl.

Fl.

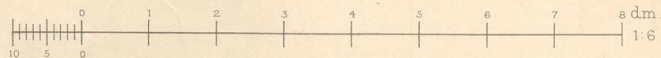
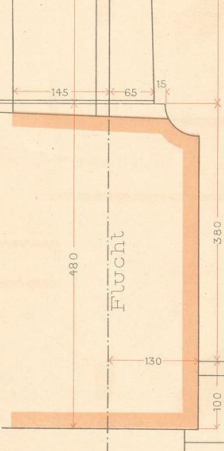
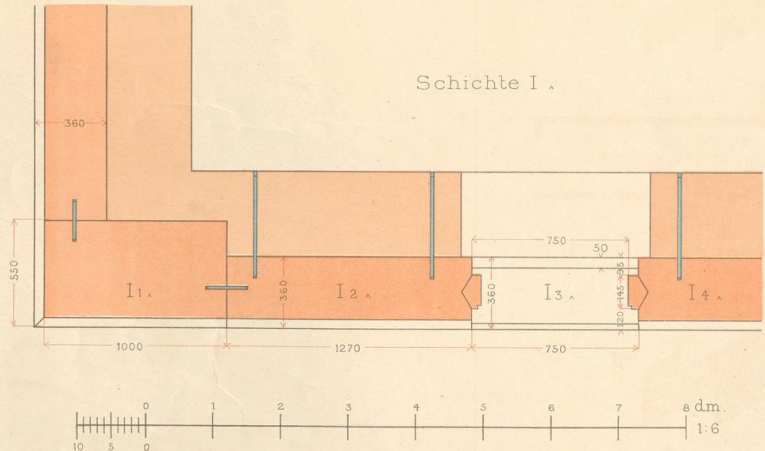
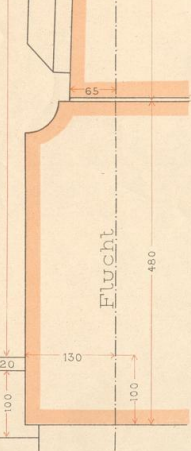
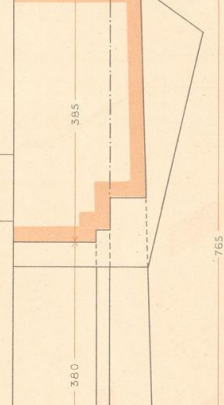
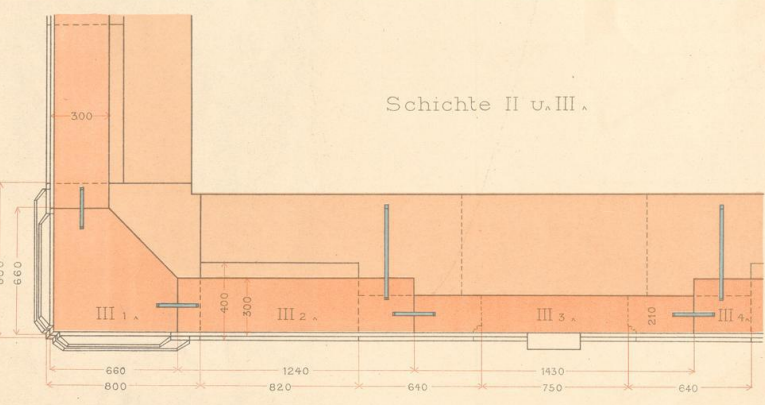
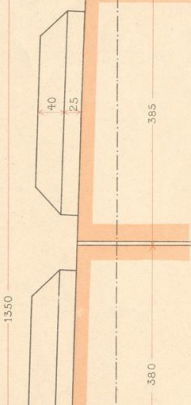
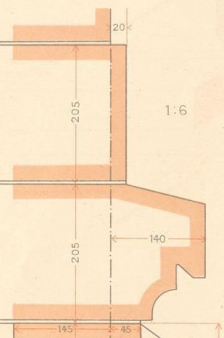
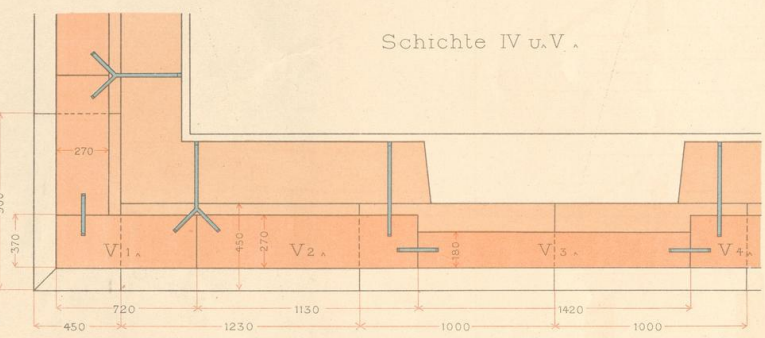
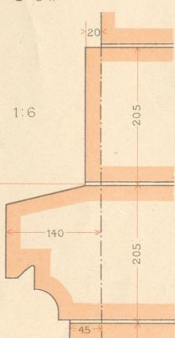

Wohnort und Datum.

Namen.

Entwurf Gebäudeanlage.

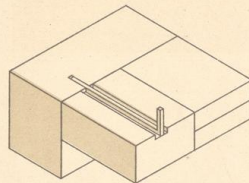
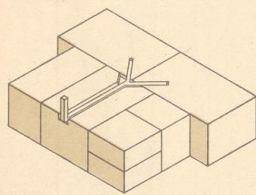
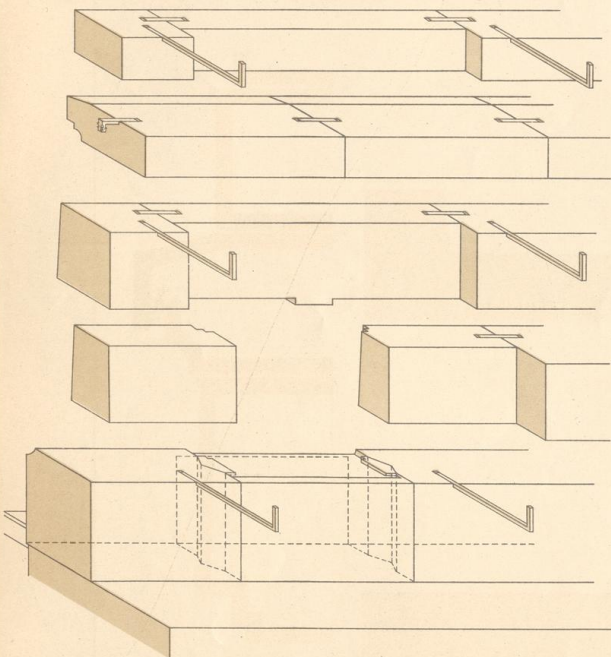
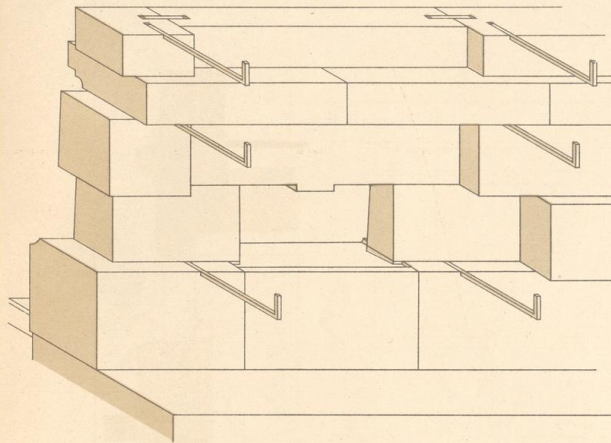

circa 2 k ϕ .

circa 1,5 k ϕ .



Klammer u. Schlaudern.

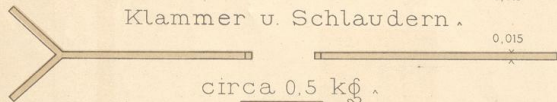

circa 0,5 k ϕ .

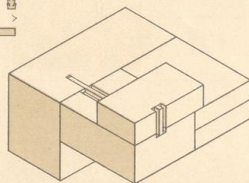
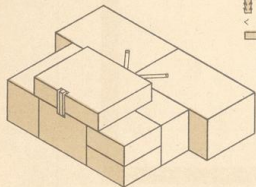



06
WTG
1199

EK 938
K D/XV

Gewänd-Schablone.

Standfüße

Schablone
zur
Fenster-Bank
II Stock 4 Stück.

Band.

Verputz

Gewänd.

Bank



Wohnort und Datum.

Details zu Blatt III 7 u. 8.

Namen.

AK 938
K O / X /



06
WTC
1/49

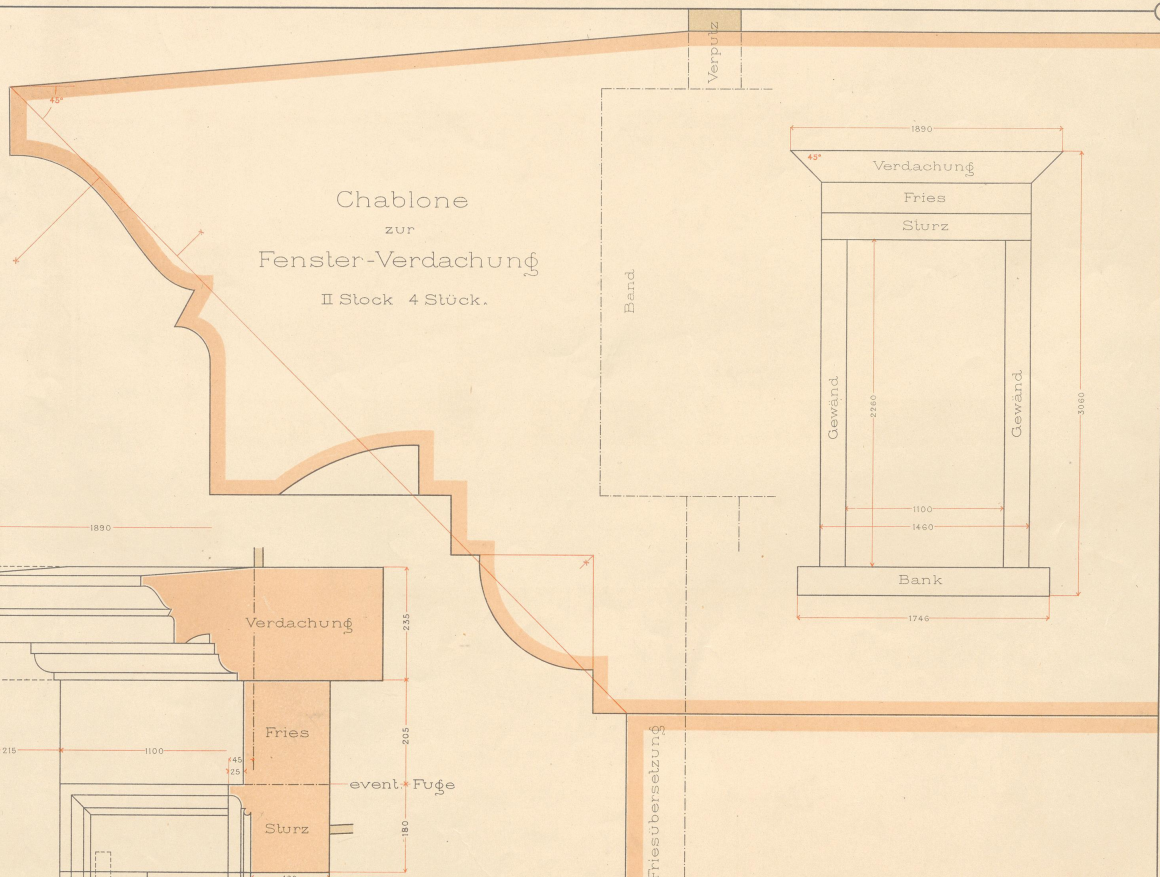

Wohnort und Datum.

Details zu Blatt III 7 u 8.

Namen.

J. Bielefeld's Verlag Karlsruhe.

Kircher, Vorlagen f. d. gewerbl. Fachunterricht.

Lith. Anst. L. Geissendorfer

EK.938
K D/XV



06
WTC
1199

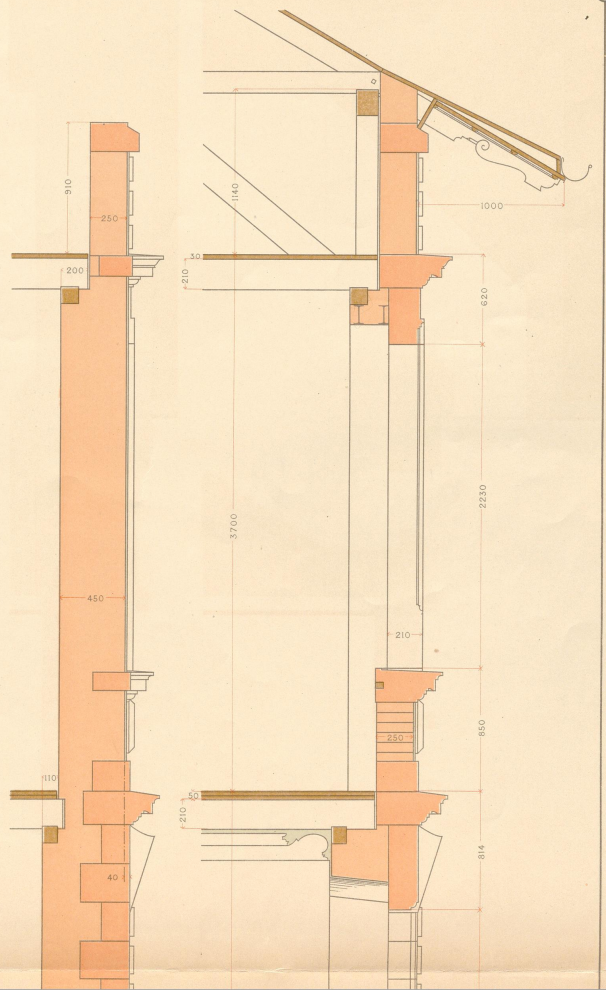
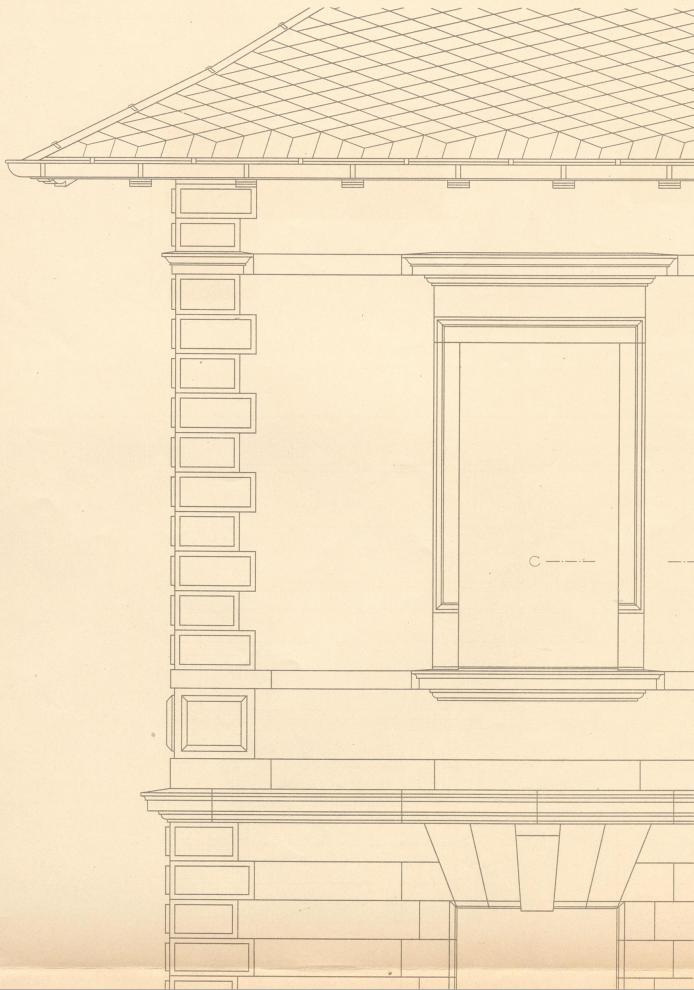

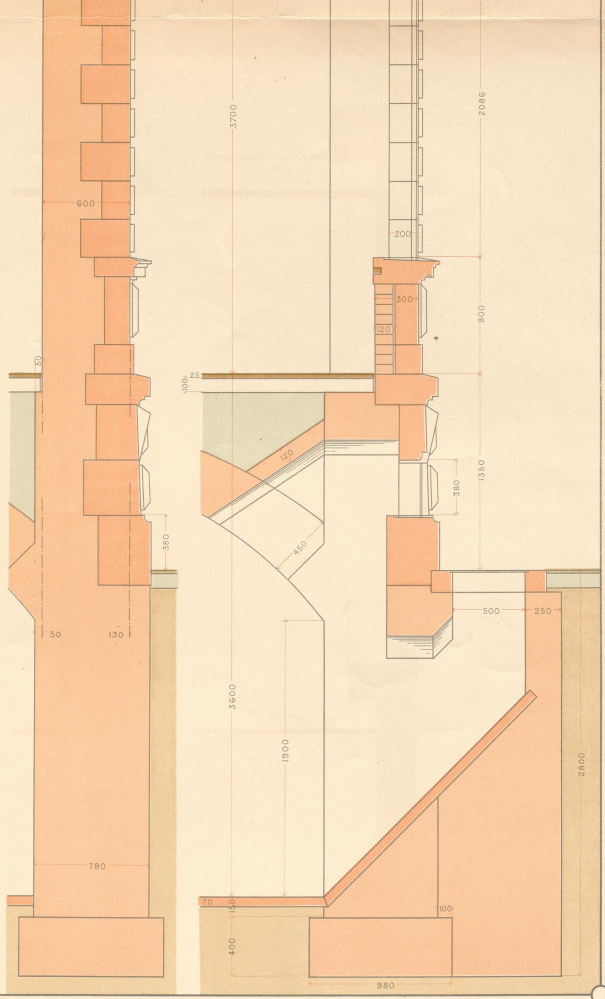
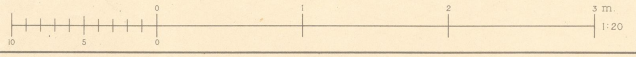
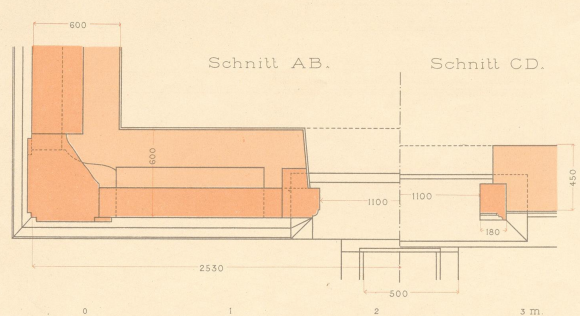
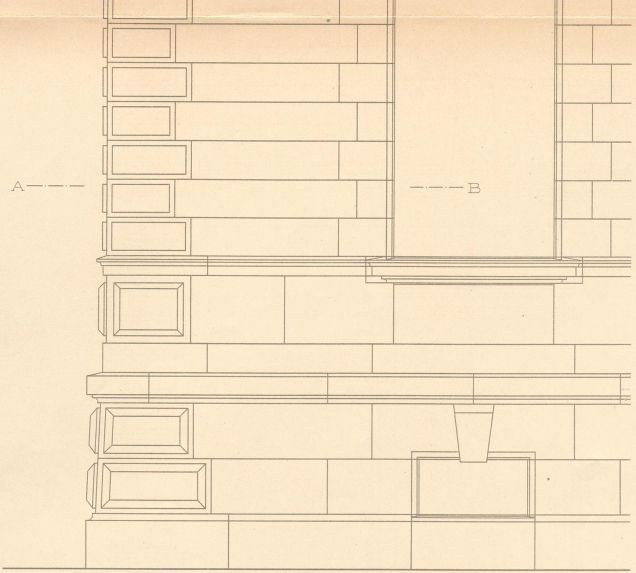

Wohnort und Datum.

Details zu Blatt 14.

Namen.

J. Bielefelds Verlag Karlsruhe.

Kirchen-Vorlagen f. d. gewerbl. Fachunterricht.

Lith. Anst. L. Geissendorfer.

K 938
K D / XV



06
076
1/199





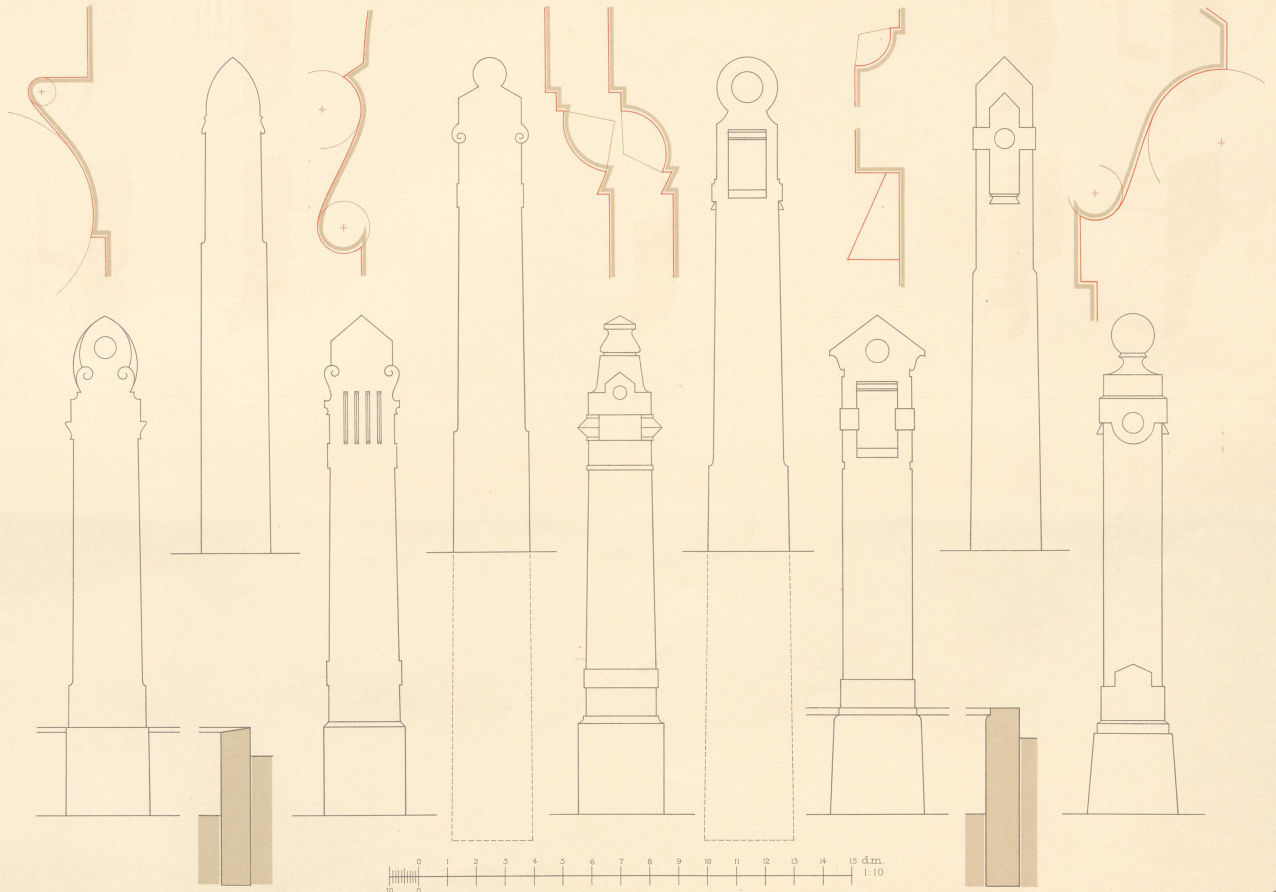

Wohnort und Datum.

Namen.

06
WTG
1/199



EK 938
K D/YV

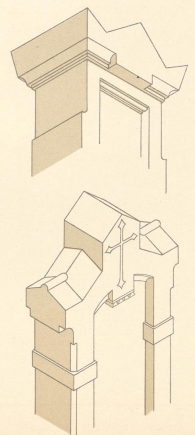
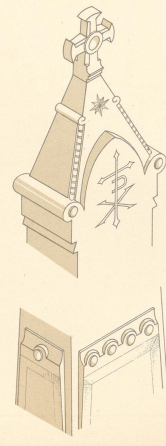
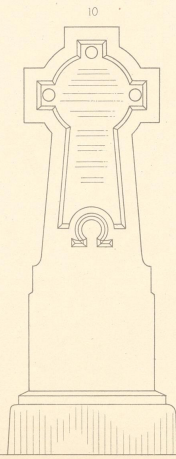
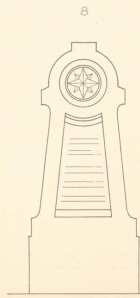
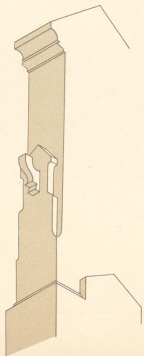
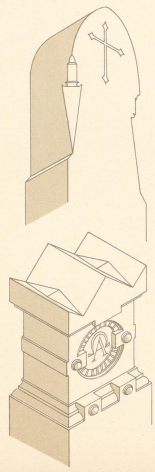

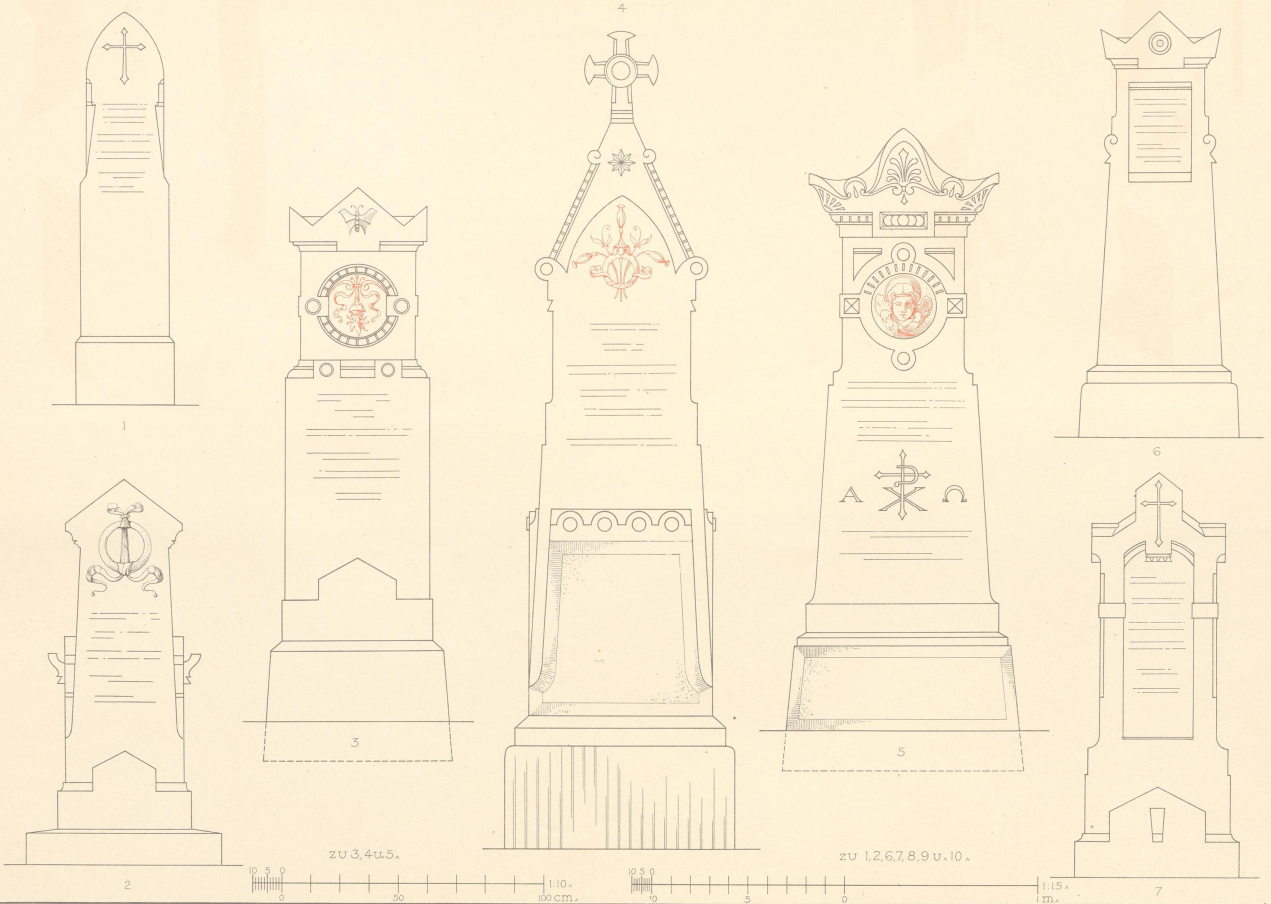

Wohnort und Datum.

Namen.

J. Bielefeld's Verlag Karlsruhe.

Kirchen. Vorlagen f. d. gewerbl. Fachunterricht.

Lith. Anst. L. Geissendörfer

06
WTG
1199



EK938
K O/XV