



UNIVERSITÄTS-  
BIBLIOTHEK  
PADERBORN

**Vorlagen für den gewerblichen Fachunterricht an  
technischen Lehranstalten insbesondere an  
Gewerbeschulen**

**Kircher, Philipp**

**Karlsruhe, [1886 - 1889]**

IV. Zimmerarbeiten.

---

[urn:nbn:de:hbz:466:1-97992](https://nbn-resolving.org/urn:nbn:de:hbz:466:1-97992)

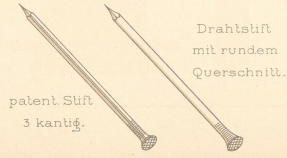
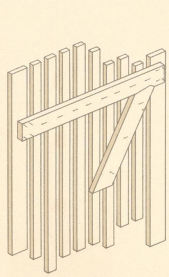

patent Stift  
3 kantig.

Drahtstift  
mit rundem  
Querschnitt.

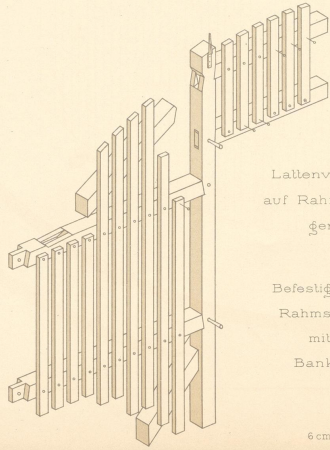

Lattenverschlag  
auf Rahmschenkel-  
geripp.

Befestigung der  
Rahmschenkel  
mittelst  
Bankeisen.

6 cm - 1 m.

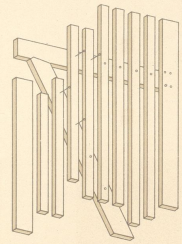
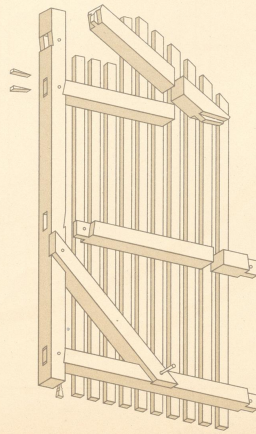

Holz  
Schraube.

Nagel von  
Schmiedeeisen.

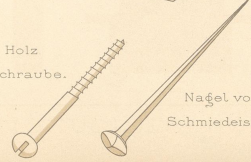

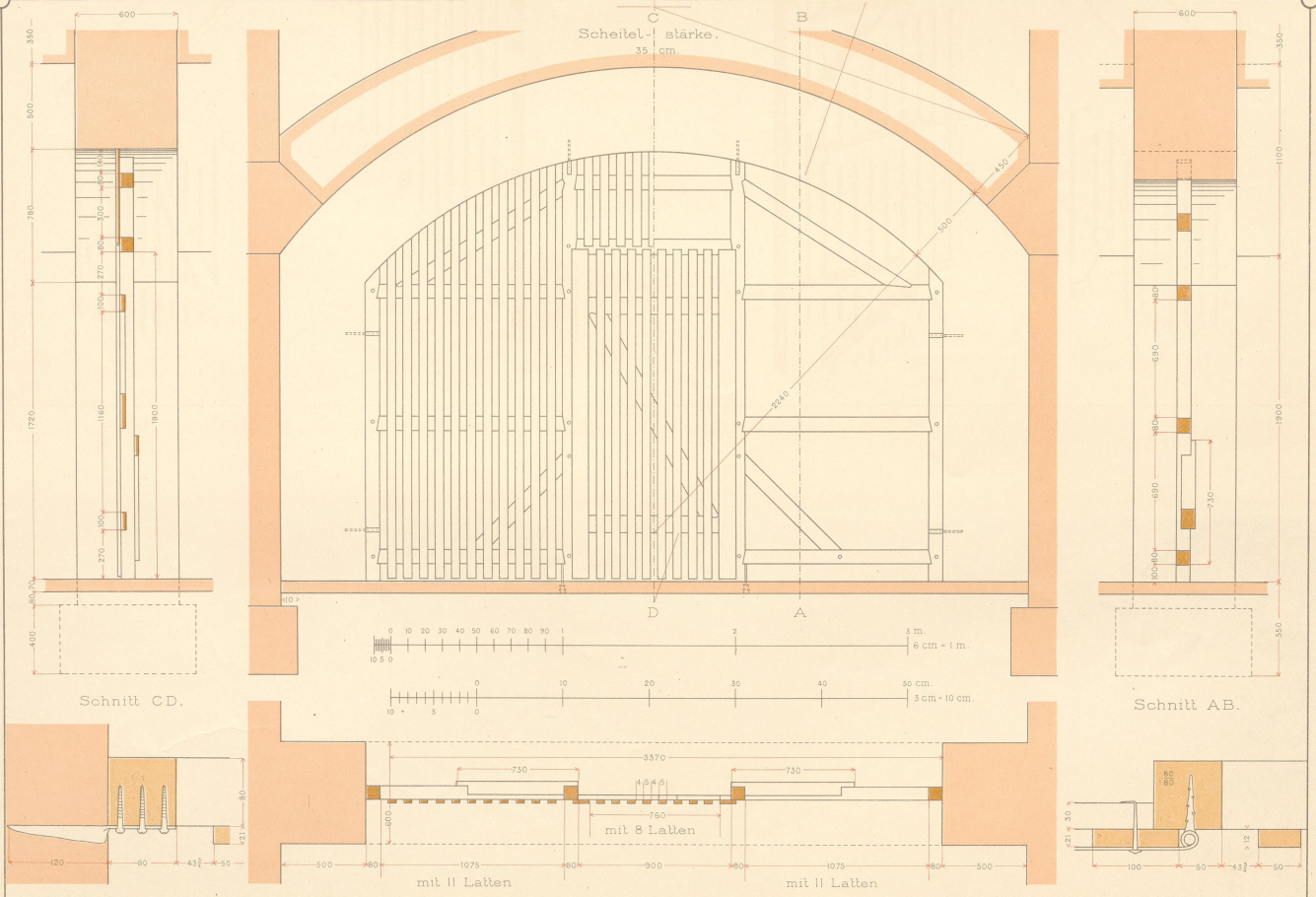

Wohnort und Datum.

Namen.



EK 938  
K D / XV



06  
1076  
1199



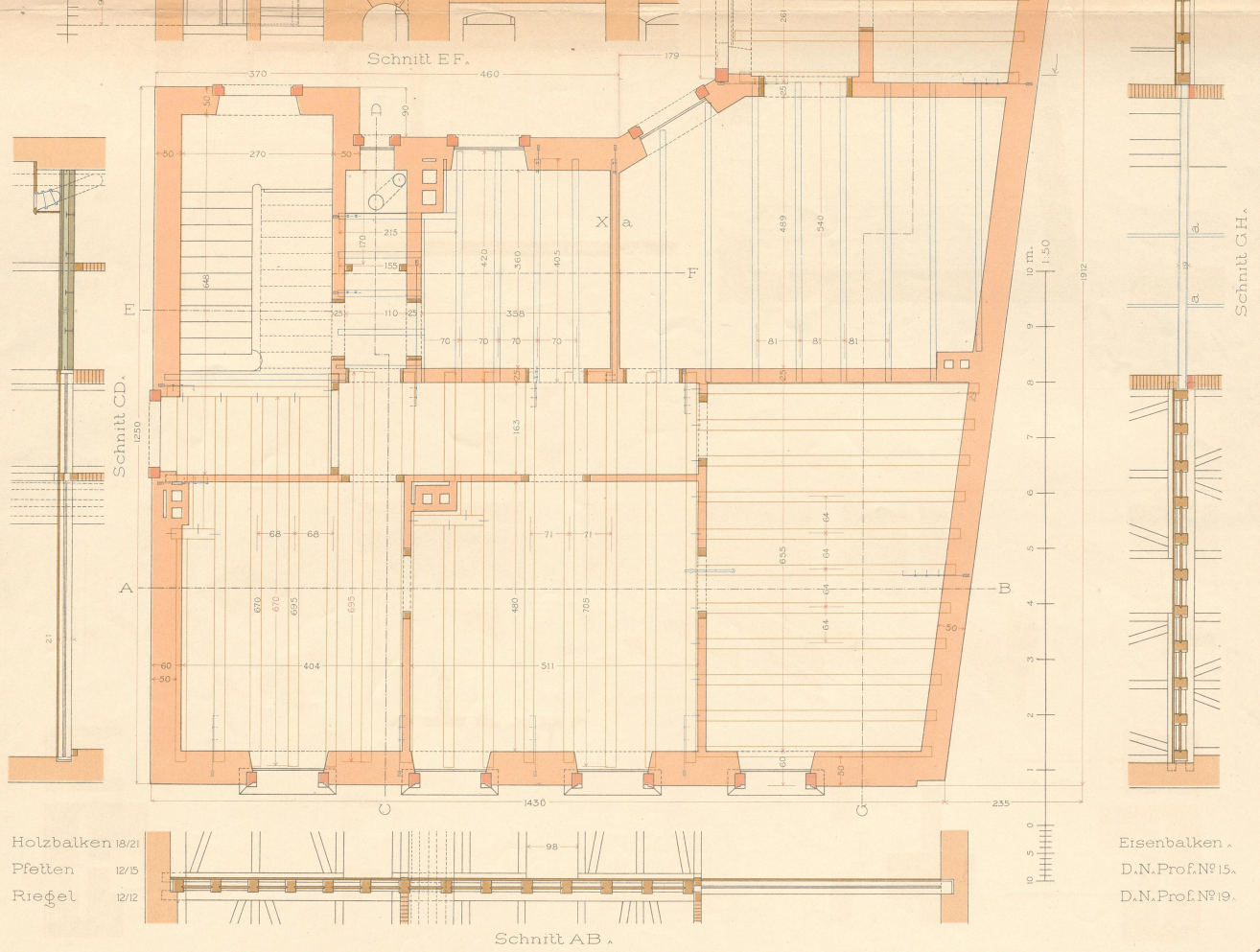

Wohnort und Datum.

Namen.

J. Bielefelds Verlag Karlsruhe.

Kircher, Vorlagen f. d. gewerb. Fachunterricht.

Lith. Anst. L. Geissendörfer.

EK 938  
K 2/XV



1876  
1/199

06

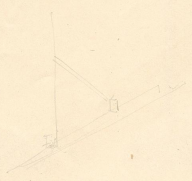

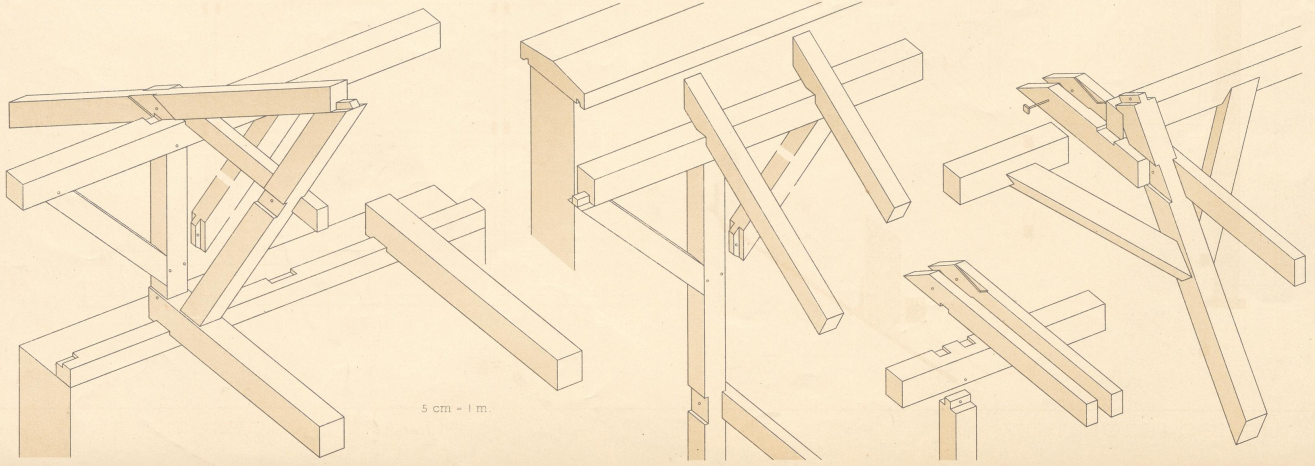

5 cm = 1 m.

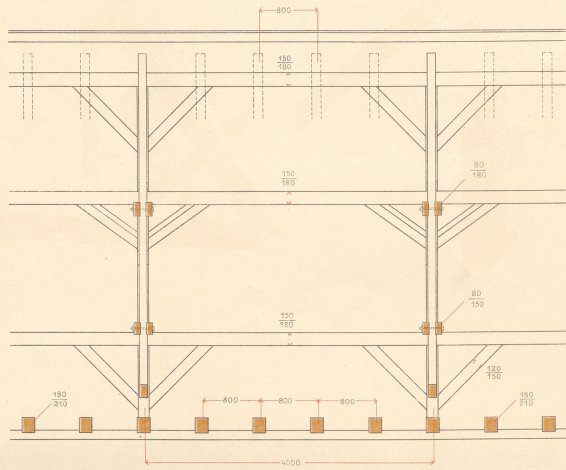

Balken Grundriss.

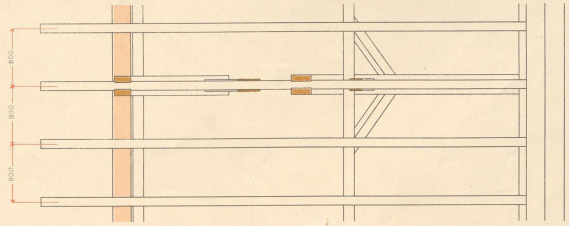
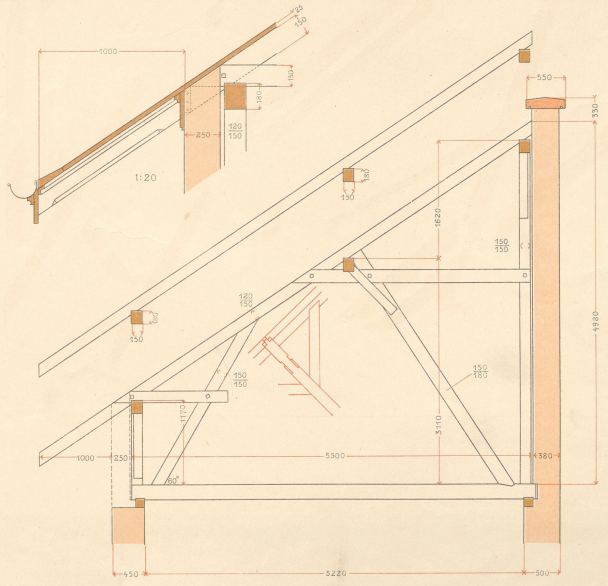
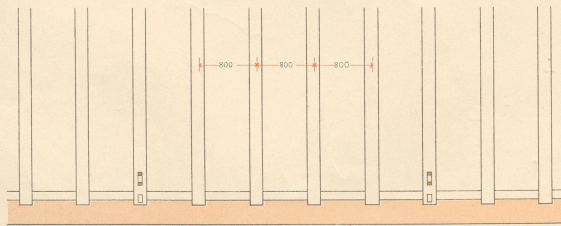

Wohnort und Datum.

Namen.

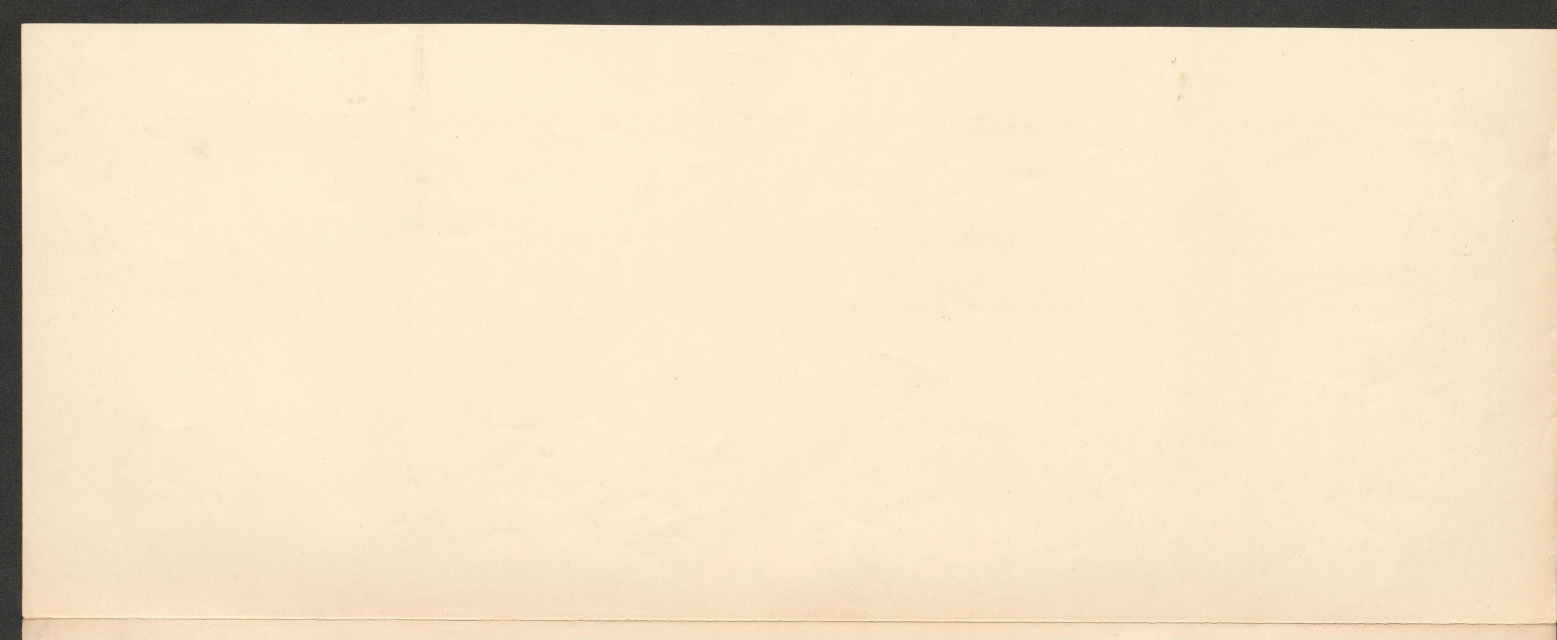

EK938  
K 2/XV



06  
MTG  
1199

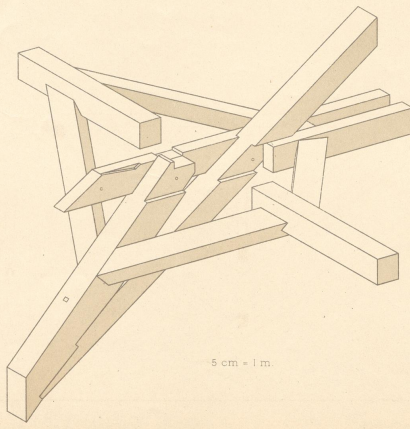
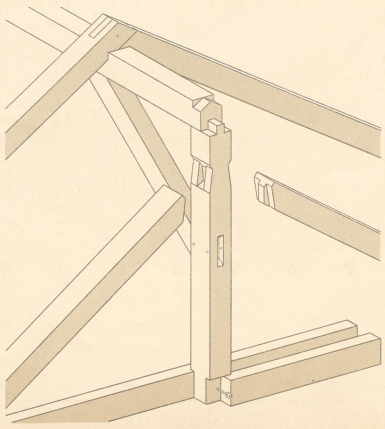

5 cm = 1 m.

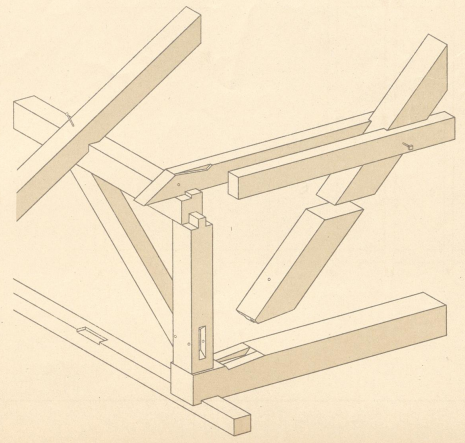





EK 438  
K D/KV



06  
WTC  
1199

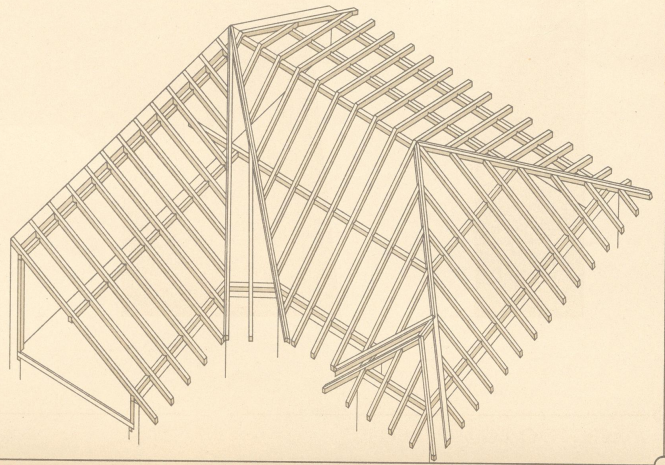
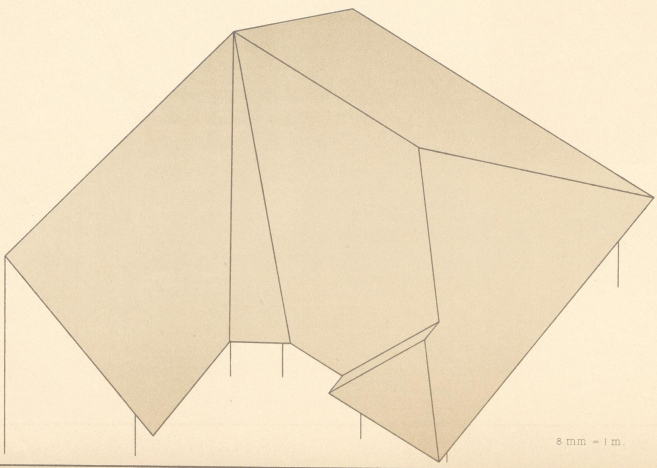

8 mm = 1 m.

Berechnung der Dachflächen.

$abcdb = aib + bcdi = \frac{vi \cdot aa'}{2} + bc \cdot cc'$	= 55,96 qm.
$bghe = (be + gh) \cdot \frac{df}{2}$	= 95,74 "
$dfg = \frac{df \cdot ef}{2}$	= 9,24 "
$ghqp = bcdi$	= 2,92 "
$hrsk = rsth + hkt = (su + vh) \cdot \frac{kl}{2} + \frac{hl \cdot wk}{2}$	= 58,50 "
$klm = \frac{kl \cdot on}{2}$	= 13,50 "
$lmz = (yr + vl) \cdot \frac{zm}{2}$	= 74,36 "
Sm. = 310,22 qm.	

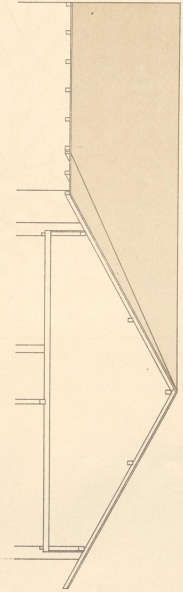
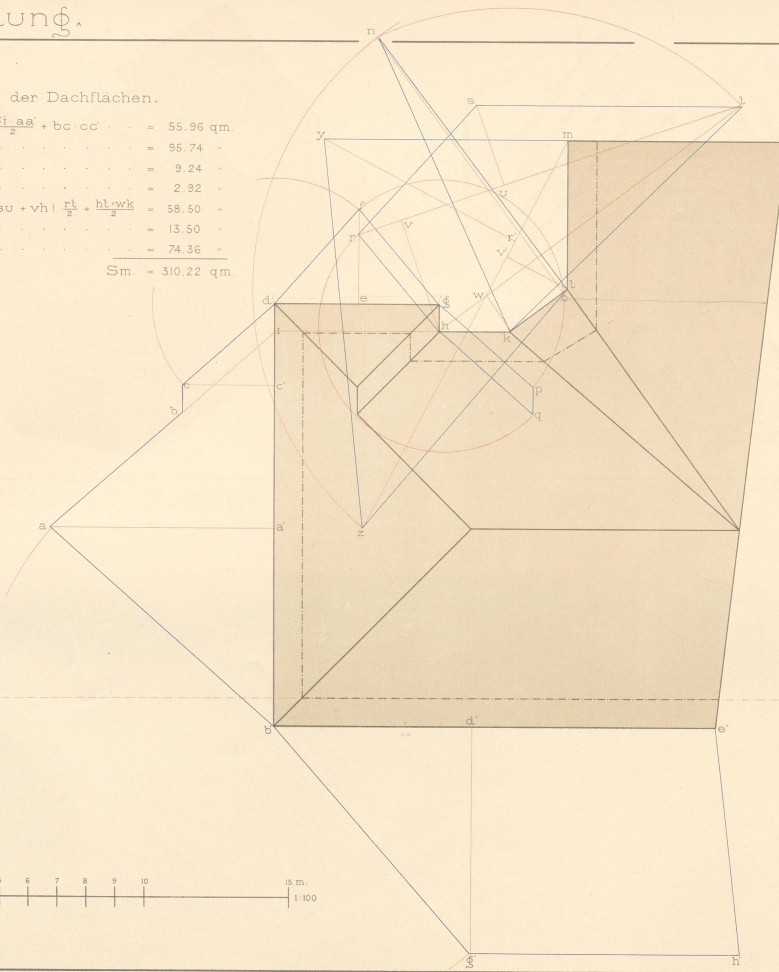
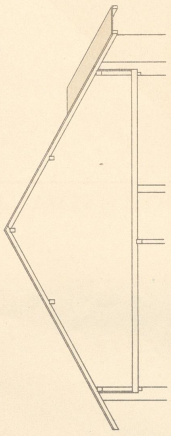

Wohnort und Datum.

Namen.



EK 938  
K D / XV



00  
210  
1199





EK 938  
K D / XV



20  
1076  
1/99



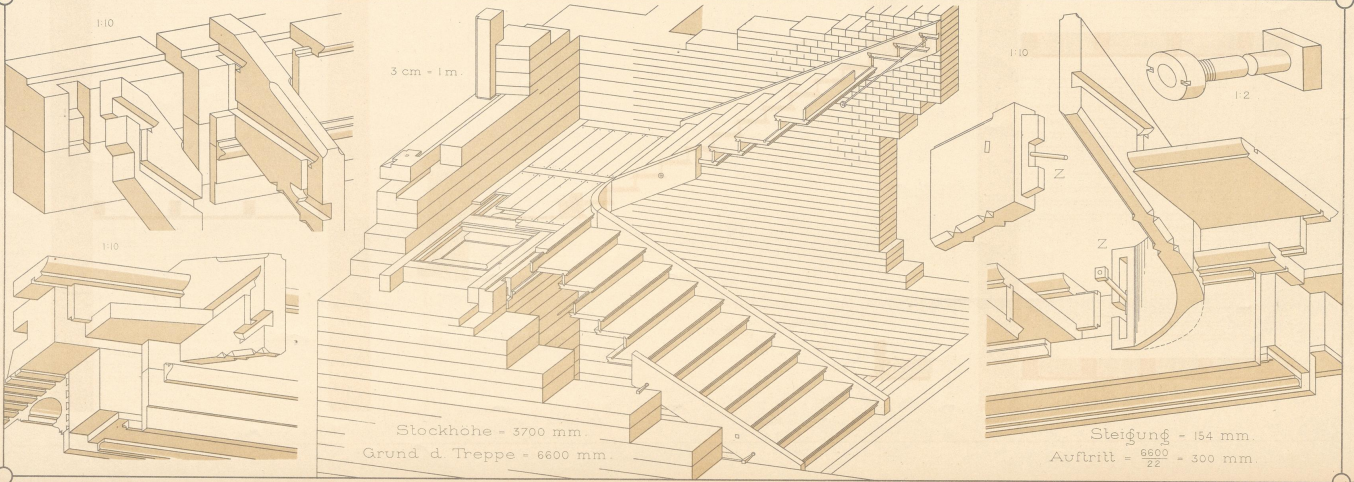

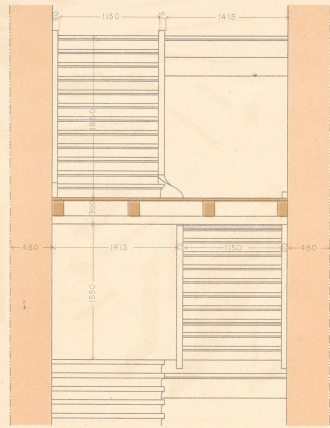

Schnitt CD.

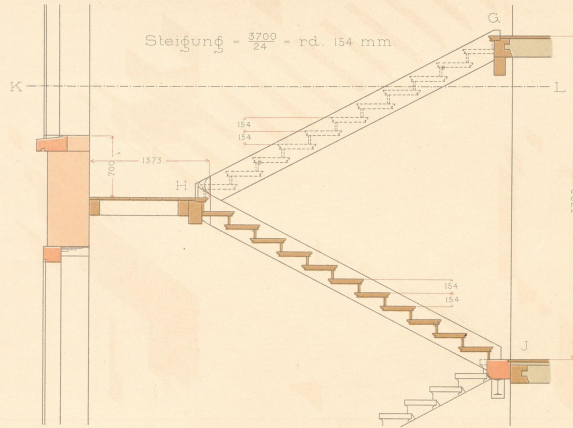

Schnitt AB.

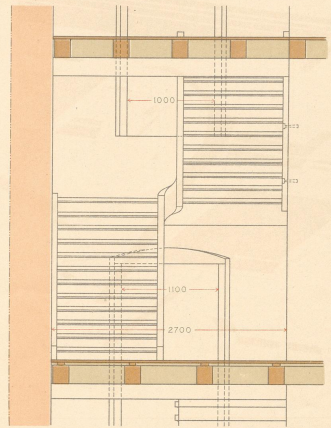

Schnitt EF.

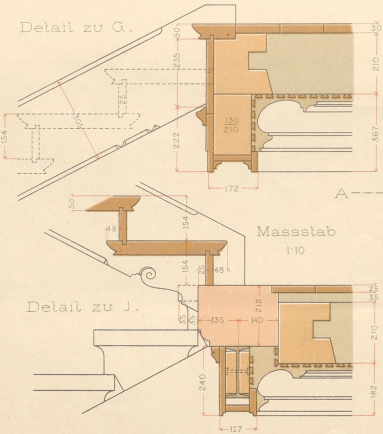

Masstab 1:10

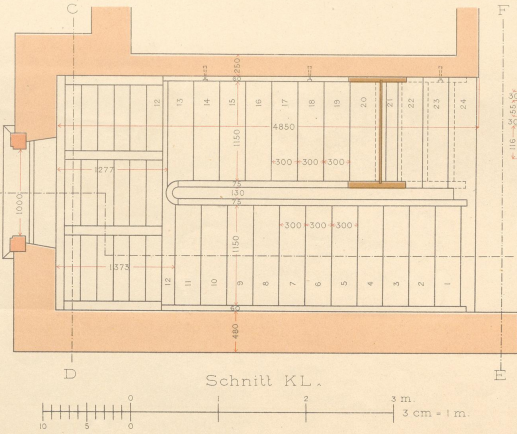

Schnitt KL.

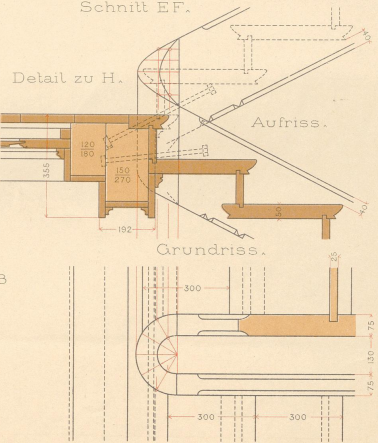

Aufriss.

Grundriss.

Wohnort und Datum.

Namen.



E 4438  
K 2 / XV



06  
576  
149

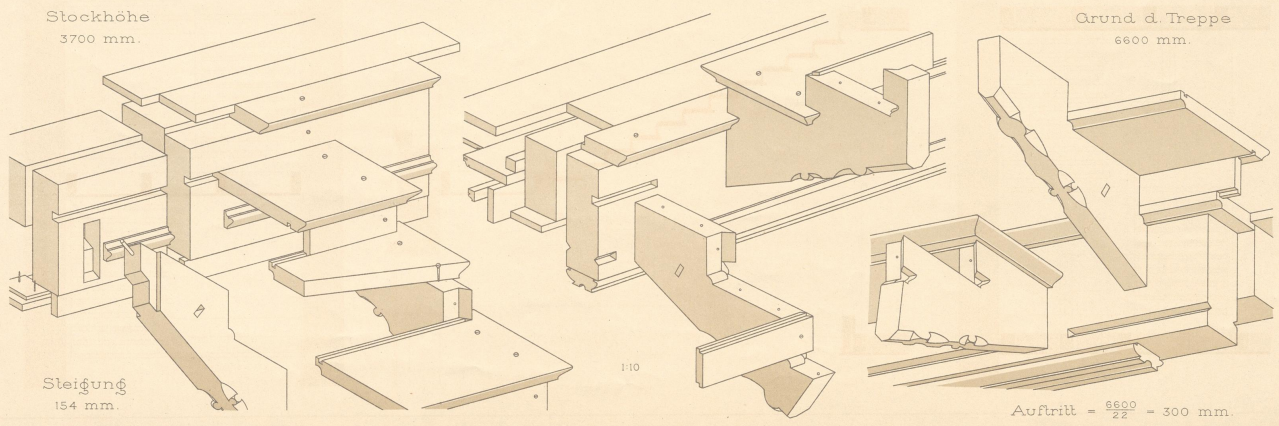





06  
WTG  
1199



EK 938  
K D / XV

# Einfache Holzstreppe.

Eckverbindung  
der Zargen.

Bestimmung der Trittbreite  
an der äusseren Zarge.

l m n o p q r s t u

Wand-Zarge.

Steigung -  $\frac{3300}{17}$  -  
 Auftritt -  $\frac{3840}{16}$  - 24  
 Grund der Treppe  
 Stockhöhe - 3300

Wohnort und Datum.



Variation.

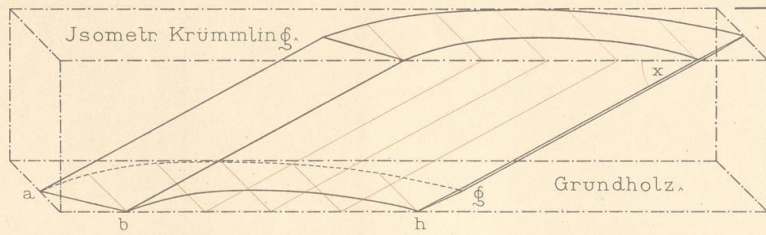

Details  
15 cm.-1m.

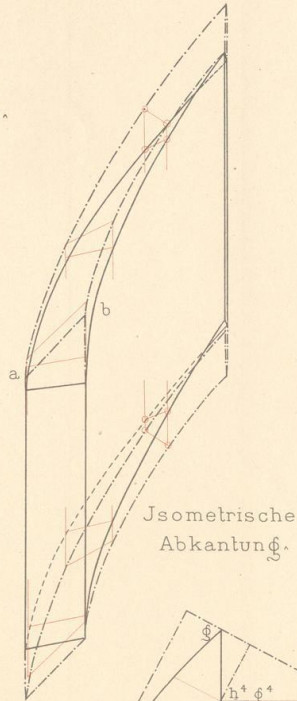

Geländerstab.

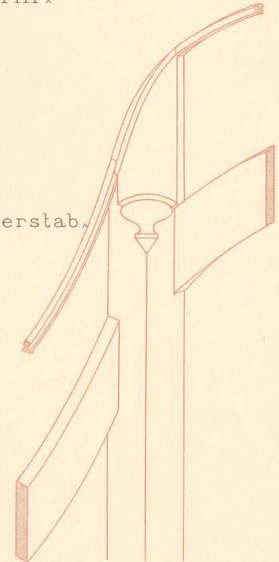

300 - rd 194 mm.  
 2 - 240 mm.  
 Treppe - 3840 mm.  
 3300 mm.

Schablone  
zum  
Krümmung.

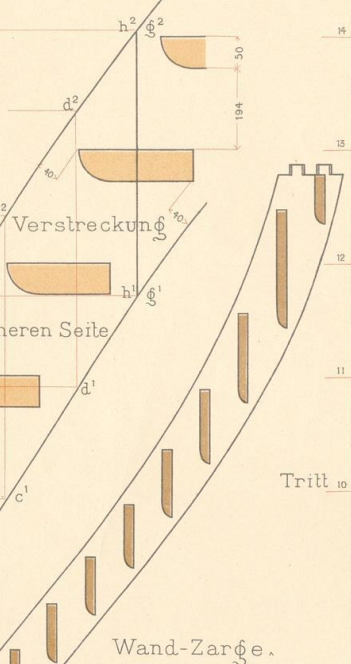
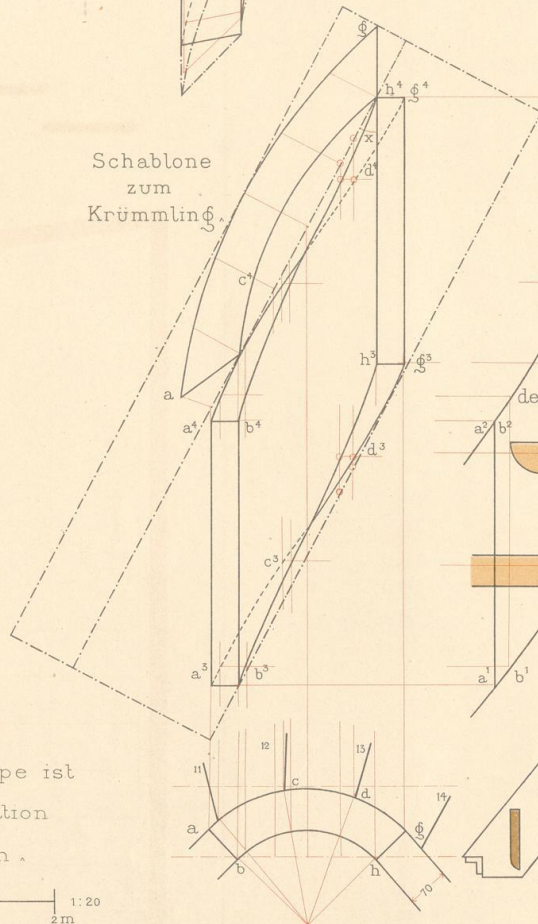

Wand-Zarge.

Schnitt AB.

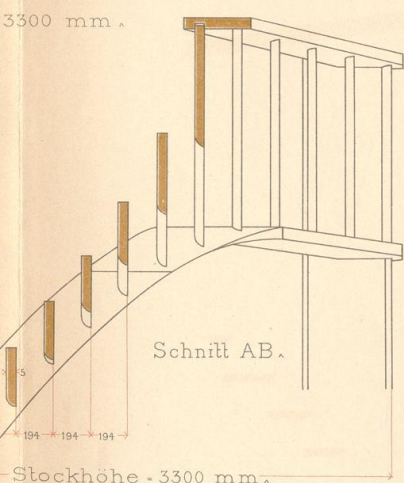

Stockhöhe - 3300 mm.

Bei einer schwer belasteten Treppe ist  
 statt des Krümmungs die Variation  
 mit dem Pfosten anzuwenden.



Namen.



K D/XV  
EK 938

1199  
1076  
96

