



UNIVERSITÄTS-  
BIBLIOTHEK  
PADERBORN

**Vorlagen für den gewerblichen Fachunterricht an  
technischen Lehranstalten insbesondere an  
Gewerbeschulen**

**Kircher, Philipp**

**Karlsruhe, [1886 - 1889]**

12. Details der Schweineställe.

---

[urn:nbn:de:hbz:466:1-97992](https://nbn-resolving.org/urn:nbn:de:hbz:466:1-97992)

Entwurf Gebäudeanlage.

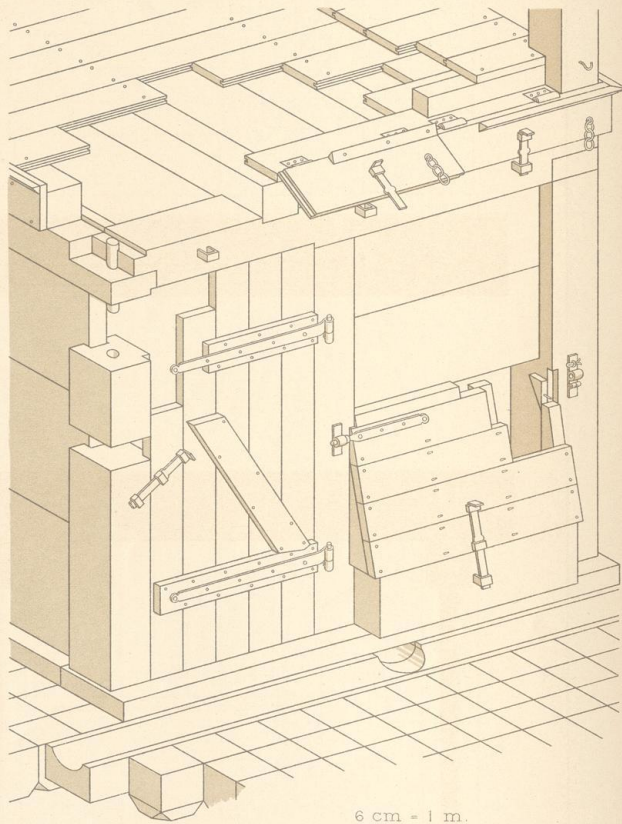
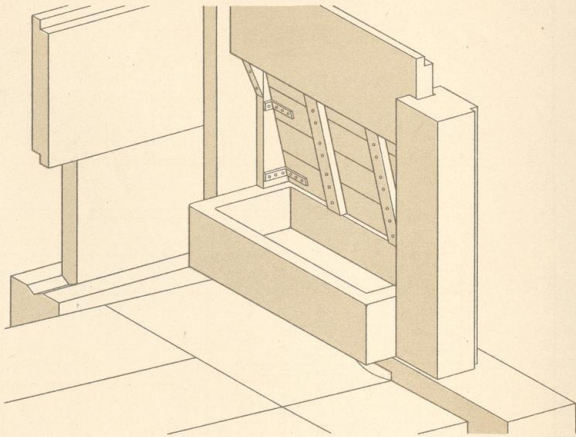

6 cm = 1 m.

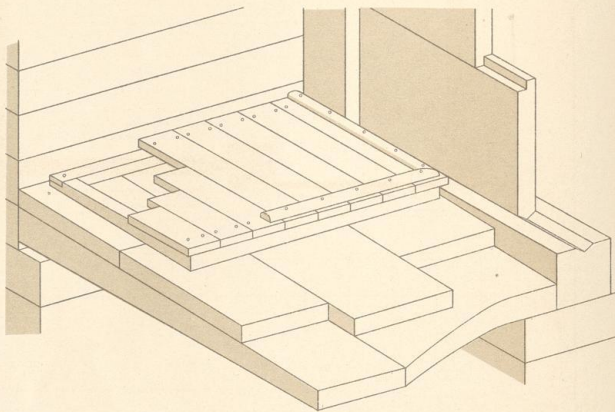

Wohnort und Datum.

J. Bielefeld's Verlag Karlsruhe.

Ansicht.

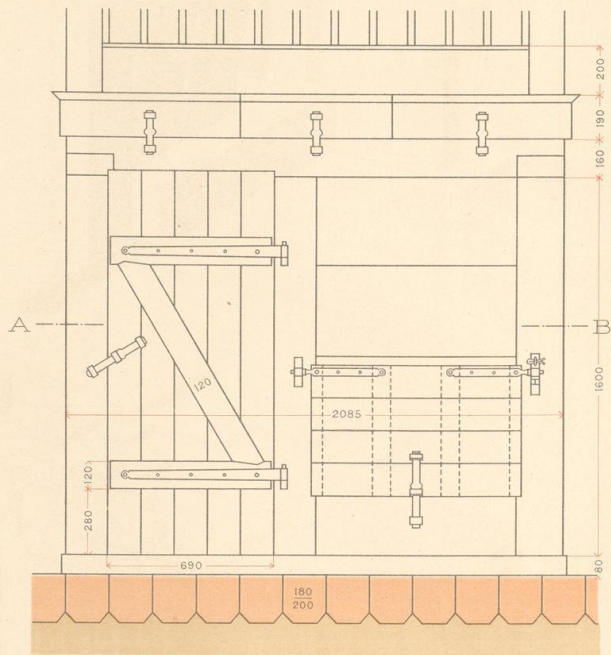

Schnitt CD.

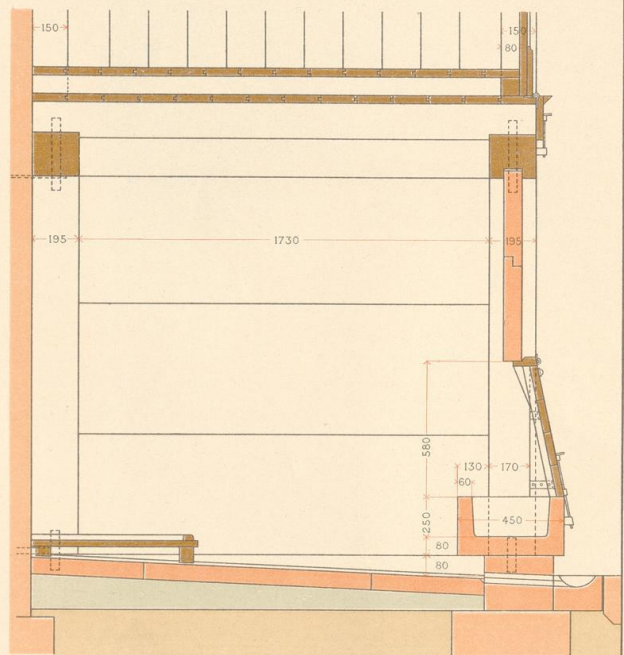

Schnitt AB.

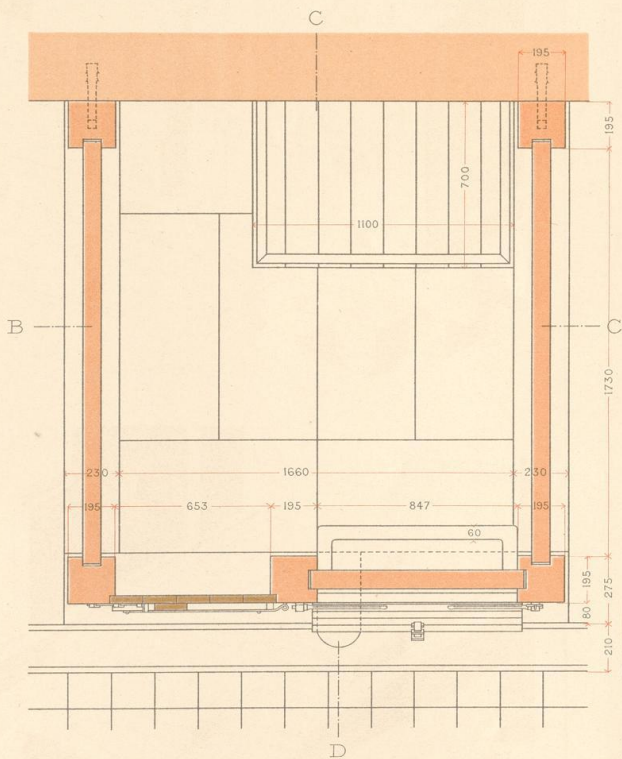

Schnitt BC.

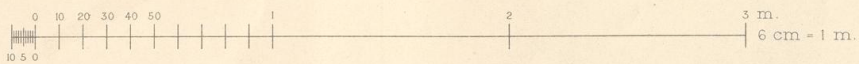
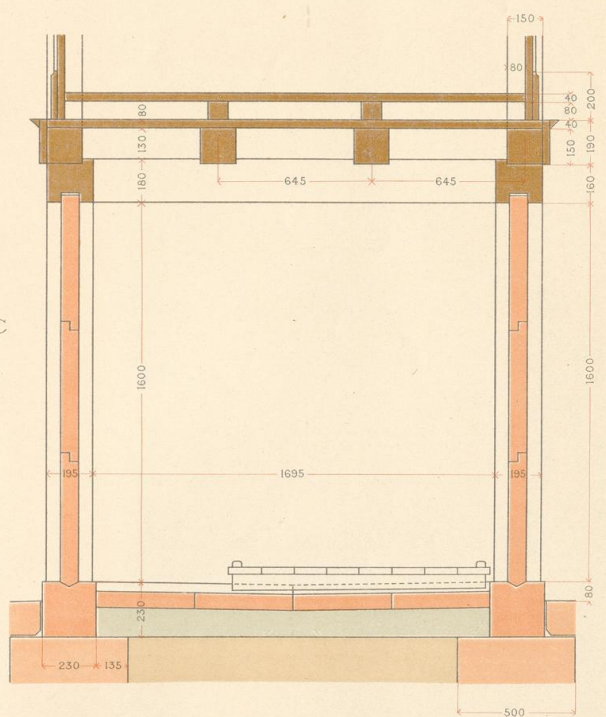

Namen.





06  
WTG  
1199

EK 938  
K D/xv