



UNIVERSITÄTS-  
BIBLIOTHEK  
PADERBORN

**Vorlagen für den gewerblichen Fachunterricht an  
technischen Lehranstalten insbesondere an  
Gewerbeschulen**

**Kircher, Philipp**

**Karlsruhe, [1886 - 1889]**

5. Dachzerfallung.

---

[urn:nbn:de:hbz:466:1-97992](https://nbn-resolving.org/urn:nbn:de:hbz:466:1-97992)

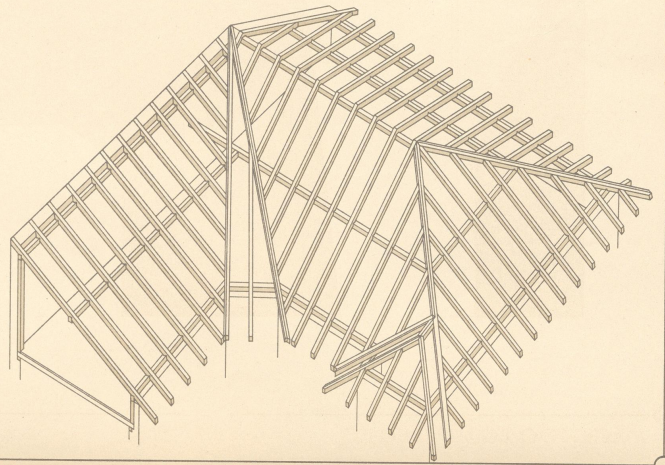
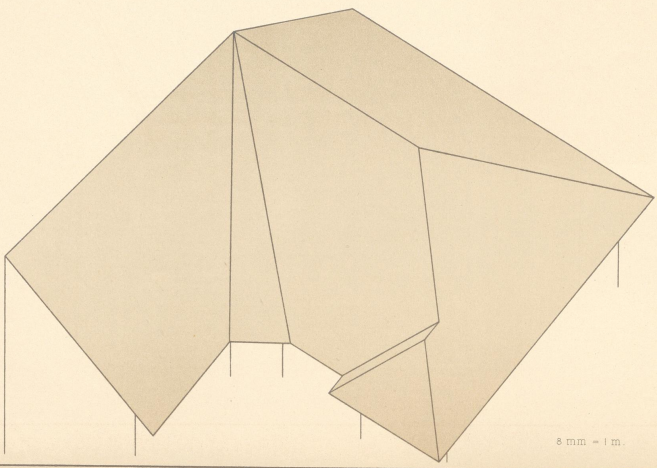

8 mm = 1 m.

Berechnung der Dachflächen.

$abcdb' = aib + bcdi = \frac{vi \cdot aa'}{2} + bc \cdot cc'$	=	55,96 qm.
$bghe = (be + gh) \cdot \frac{df}{2}$	=	95,74 "
$dfg = \frac{df \cdot ef}{2}$	=	9,24 "
$ghqp = bcdi$	=	2,92 "
$hrsk = rsth + hkt = (su + vh) \cdot \frac{kl}{2} + \frac{ht \cdot wk}{2}$	=	58,50 "
$klm = \frac{kl \cdot on}{2}$	=	13,50 "
$lmz = (yr + vl) \cdot \frac{zm}{2}$	=	74,36 "
Sm. =		310,22 qm.

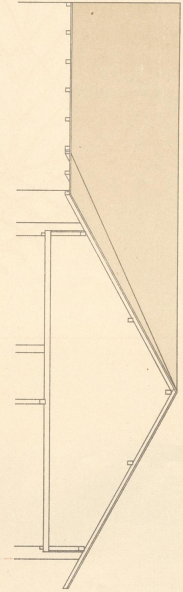
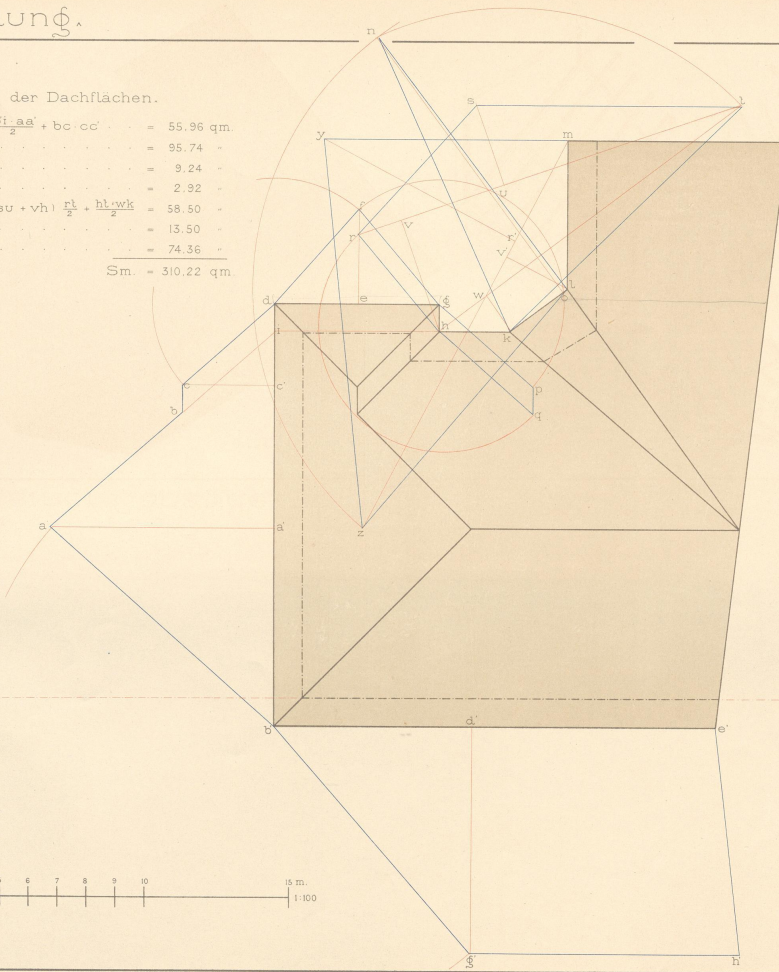
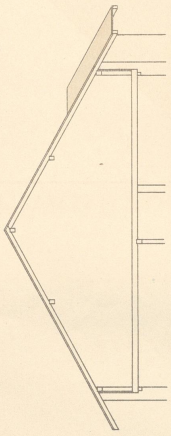

Wohnort und Datum.

Namen.



EK 938  
K D / XV



00  
210  
1199